

BILL OF MATERIALS			
ITEM #	PART #	QTY	DESCRIPTION
1	010764	1	BAG, PLASTIC 4" X 8"
2	012408	4	NUT, KEP 10-24 ZP
3	012795	4	#10-24 X 1/2" UNSLOTTED HEX
4	501406	1	6" X 6" X 4" CARTON
5	730282	1	1-1/2" SS HOSE CLAMP
6	730489	1	730465 PKG. LIST
7	750418	1	PROX SENSOR, 44R-33, 90-265V
8	780055	1	PROX SENSOR BASE W/HOLE

NOTE: NOT ALL ITEMS IN ASSEMBLY ARE SHOWN, INCLUDING:

- 1. 010764 BAG
- 2. 501406 CARTON
- 3. 730489 PACKING LIST

REFERENCE VIEW SCALE: 1:4

SHOWN ASSEMBLED TO STEEL DISCHARGE HEAD,
ALSO USED ON PLASTIC DISCHARGE HEAD

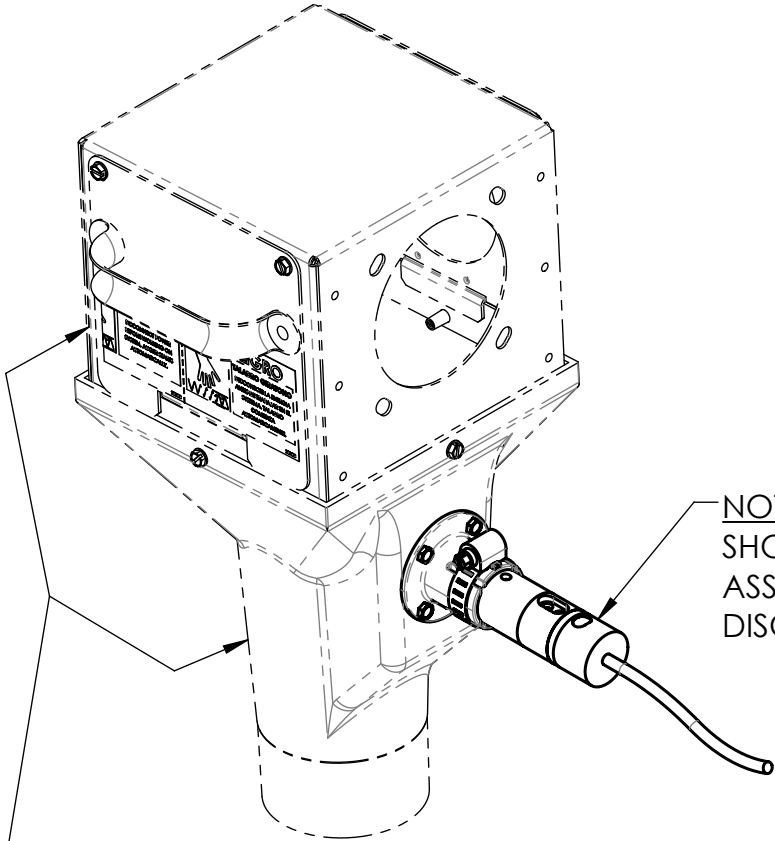

NOTE: PARTS SHOWN FOR REFERENCE ONLY.

730465
REV. C
SHEET 1

REV	ECN#	DESCRIPTION	DATE	BY
A	13747	CREATE SOLIDWORKS DRAWING; REMOVE 730479.	1/27/17	TRC
B	13934	750418 [A] PROX SENSOR WAS 750418 [-].	8/15/2017	NJB
C	14731	780055 WAS 730275	8/1/2019	LRA

NOTE: SHOWN ASSEMBLED FOR REFERENCE ONLY. DO NOT SHIP ASSEMBLED.
STAPLE BOTTOM OF 501406 CARTON AND SET UPRIGHT.
PLACE (4) 012795 BOLTS, (4) 012408 NUTS, AND (1) 730282 CLAMP IN 010764 BAG.
PLACE BAG IN CARTON WITH 730275 ADAPTER, 750418 SENSOR, AND 730489 PACKING LIST.
STAPLE TOP OF CARTON SHUT AND PLACE LABEL ON SIDE.

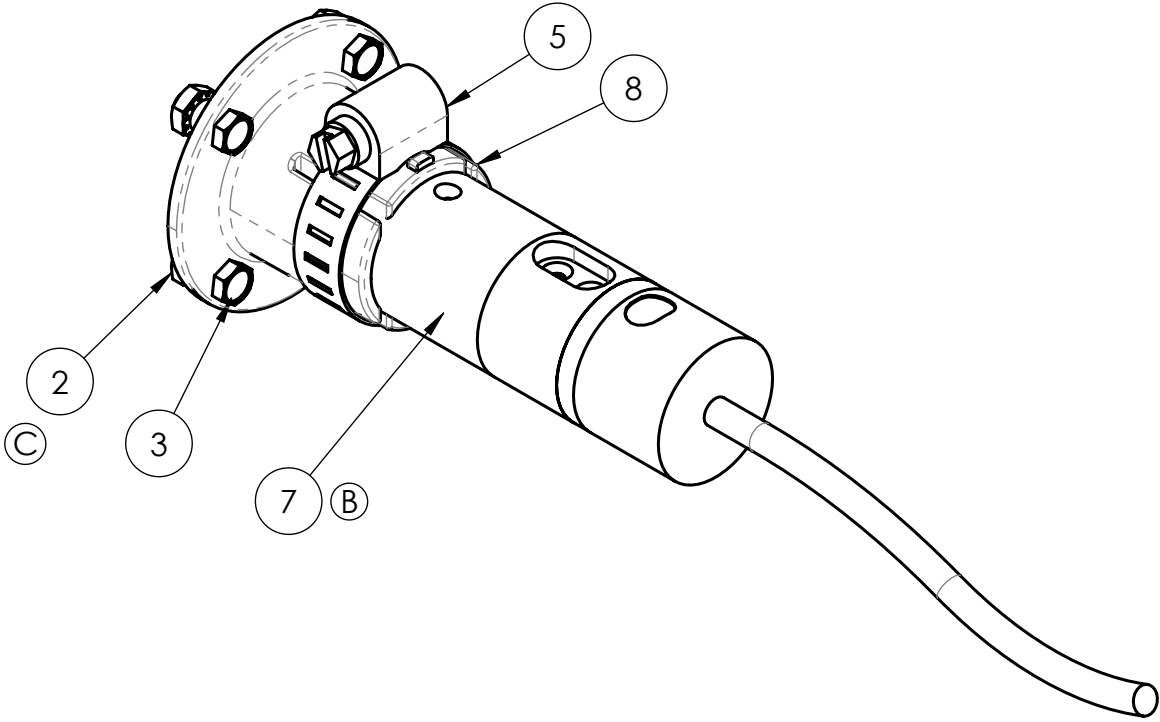

UNSPECIFIED TOLERANCES
2 PLACE ± .060
3 PLACE ± .030
4 PLACE ± .010
HOLE DIA. ± .010
ANGULAR ± 1°

DIMENSIONS ARE IN INCHES
DIMENSIONS IN ()
ARE MILLIMETERS
UNLESS OTHERWISE
SPECIFIED.
DO NOT SCALE



VALCO COMPANIES, INC.

PO BOX 8
NEW HOLLAND, PA 17557

This drawing and any print thereof is the property of VALCO COMPANIES INC. and is subject to return on request by this company. The information shown is confidential and the recipient by accepting this drawing agrees not to use any information contained thereon in any manner which will be detrimental to VALCO COMPANIES INC.

DATE 1/12/17

DRAWN TRC

CHECK

WEIGHT 0.388

SCALE 1:1.5

DESCRIPTION 1 PROX SENSOR W/MOUNT & HDWE

DESCRIPTION 2

SHEET 1 OF 1

730465

REV. C