



Quick Sheet Instructions

Hog Drinker System Nursery and Wean to Finish

OVERVIEW

The Val-Co stainless steel hog drinker system provides just the right amount of water and reduces spillage for nursery and wean to finish applications. The cup protects the drinker nipple and allows a small amount of water to attract hogs to drink. This versatile system may be mounted on a steel gate using the backing plate, back-to-back, or on a concrete divider wall (not shown).

NOTE: Val-Co does not provide hardware for concrete installations, as these are site specific. Check the parts lists on page 6 to make sure you receive the proper components for your application.

NURSERY APPLICATION

BACK PLATE AND
BACK TO BACK OPTION

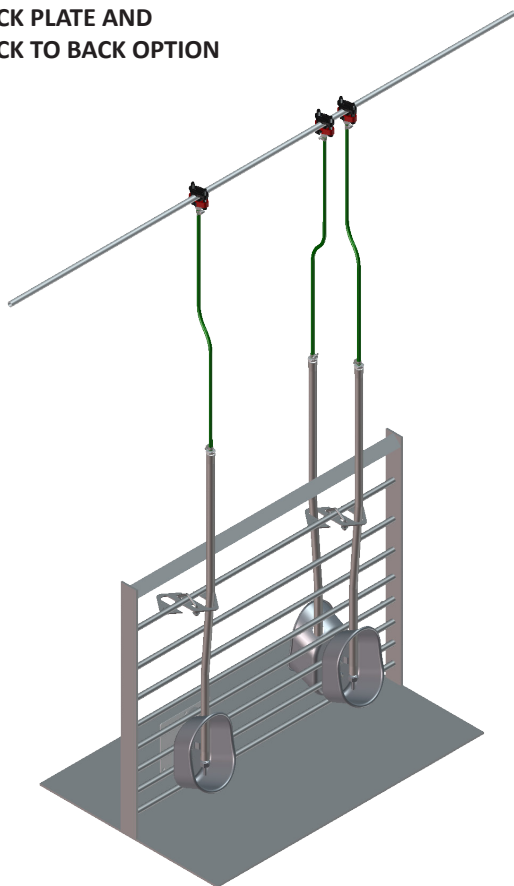

WEAN TO FINISH APPLICATION

BACK PLATE AND
BACK TO BACK OPTION

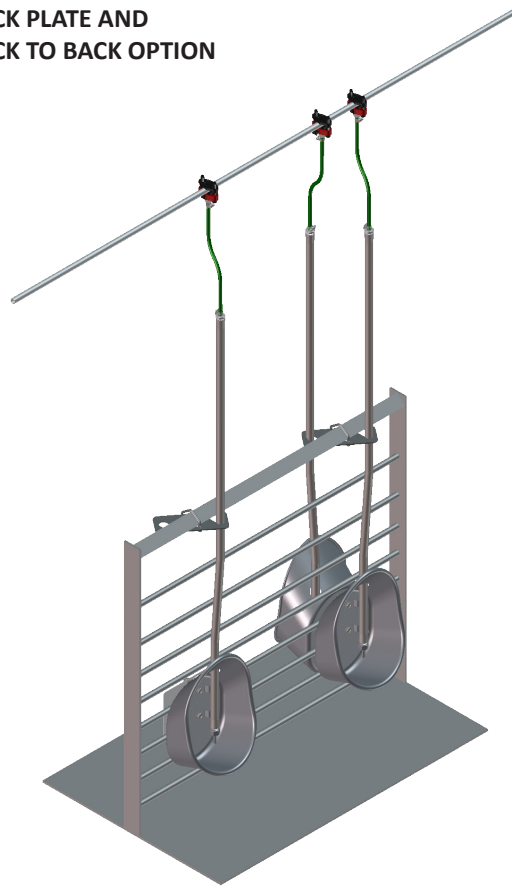

ASSEMBLY INSTRUCTIONS

1. Begin by removing the filter cap from the nipple.
(Nipple options shown on page 6.)
2. Adjust the flow selector to the desired diameter. (For more detail on selecting the best diameter, please refer to the nipple output data chart on the next page.)



The #781006 nipple is easy to actuate and can be used for nursery applications as well as wean to finish application.

Figure 1 - 781006 Filter Cap Assembly Removed

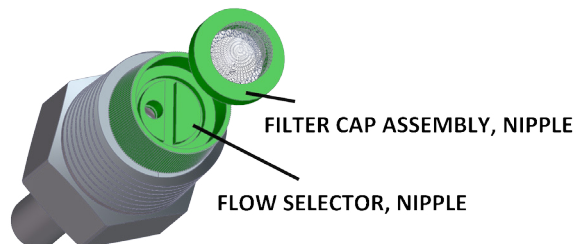

NIPPLE OUTPUT DATA

SUPPLY PRESSURE @ NIPPLE P.S.I. (kPa)																
PSI	5	6	7	8	9	10	11	12	13	14	15	16	17	18	19	20
kPa	34.5	41.4	48.3	55.2	62.1	68.9	75.8	82.7	89.6	96.5	103.4	110.3	117.2	124.1	131	137.9
FLOW SELECTOR HOLE DIAMETER	NIPPLE VOLUME OUTPUT (BASED ON SUPPLY PRESSURE AND FLOW SELECTOR SETTING)															
0.030"	12.8	13.7	14.4	15.4	16	17	17.5	18.2	18.7	19.2	19.2	19.2	19.6	19.7	20	20.5
.76mm	0.38	0.41	0.43	0.46	0.47	0.5	0.52	0.54	0.55	0.57	0.57	0.57	0.58	0.58	0.59	0.61
0.050"	28.8	31.4	32.6	35.2	35.8	37.1	37.8	38.4	39	39.7	43.5	44.2	45.4	46.7	48	49.3
1.27mm	0.85	0.93	0.96	1.04	1.06	1.1	1.12	1.14	1.15	1.17	1.29	1.31	1.34	1.38	1.42	1.46
0.100"	64	70.4	76.8	82.6	85.8	89.6	95.4	96	98.6	102.4	106.2	108.8	113.9	116.8	119	122.9
2.54mm	1.89	2.08	2.27	2.44	2.54	2.65	2.82	2.84	2.92	3.03	3.14	3.22	3.37	3.45	3.52	3.63
		OUTPUTS GIVEN IN OUNCES PER MINUTE														
		OUTPUTS GIVEN IN LITERS PER MINUTE									TEST PERFORMED 9/22 & 9/23/05					



Use a flat head screwdriver to turn the flow selector to the desired hole diameter.



Insert the filter cap assembly before you move to next step!

Nipple Hole Diameter View

Figure 2

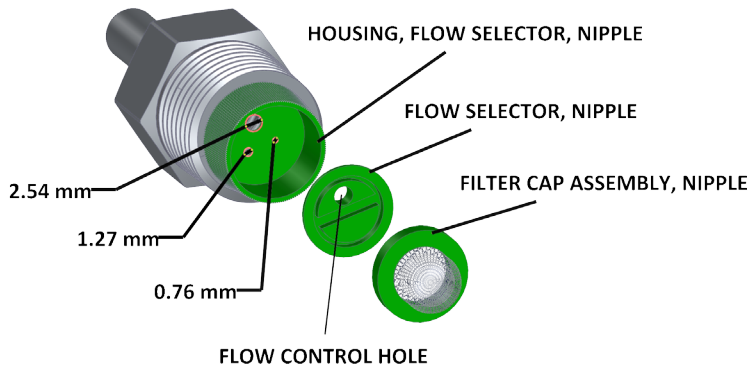

Assembled

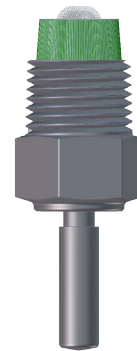

- Once the nipple filter cap is re-inserted, attach the nipple assembly to the bottom end of the **#RDSS36P**, nursery or **#RDSS48PAD**, wean to finish, pipe/bracket (welded) assembly by turning it clockwise into the end of the pipe, as shown in Figure 3 and 4.

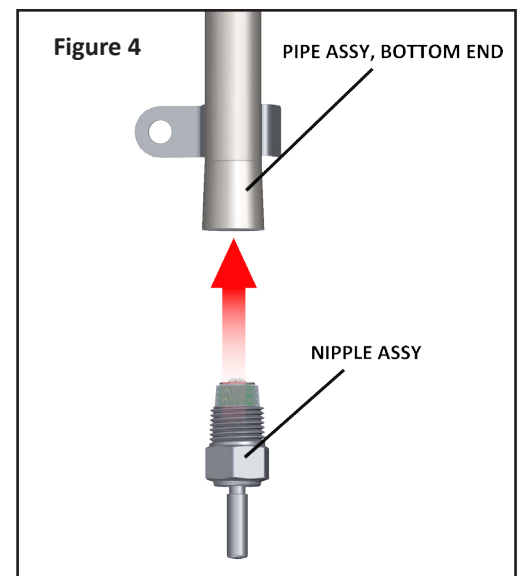
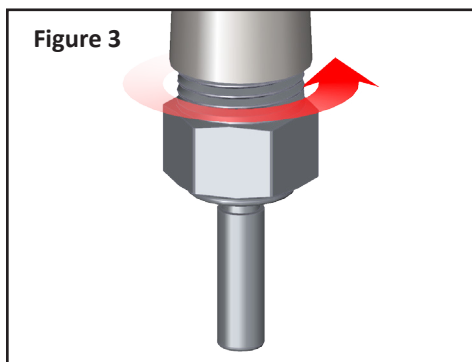

INSTALLATION

Determine the best location to mount the hog drinker system. Drinker cups should be easily accessed by the hogs and the hose/fittings should be well above the hogs' reach.

The assembly order may vary depending on preference. If you are installing many cups, install one fully to determine the exact length you will need for the hose between the drinker pipe and the pipe connector shut off saddle, then you can cut the hoses and pre-assemble the adapters and clamps before installing the remaining drinker cups, provided all cups are equal distance from water supply pipe.

1. Insert the **#RDSS48PAD** pipe assembly through the bottom side of the hole (at the top) of the **#781000** wean to finish cup, as shown in Figure 5 & 6. *(The process is the same for the nursery system using **#RDSS36P** pipe assembly and **#781001** nursery cup. The hole is large enough to maneuver the pipe into place.)*
2. Align the hole(s) on the pipe bracket(s) to the matching hole(s) on the back of the drinker cup, as shown in Figure 7. Attach the pipe bracket(s) (1 for nursery and 2 for wean to finish assy.) to the back of the cup using the **#690299** 5/16" pan screw, **#MH8033** flat washer(s) and **#MH90044** nylock nut(s) and tighten securely, as shown in Figure 7.
3. Attach the cup(s) to the gate, approximately 2" off the floor for nursery application and 4.7" for wean to finish application, using the **#RDWFN-BP** back plate or back to back option, as shown in Figure 8 & 9 on the next page, and secure with the **#690302** hex head bolts, **#MH8033** flat washers and **#MH90044** nylock nuts.

Figure 5

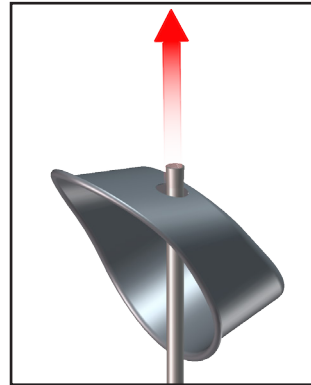

Wean to Finish Assy (2) brackets
Nursery Assy (1) bracket

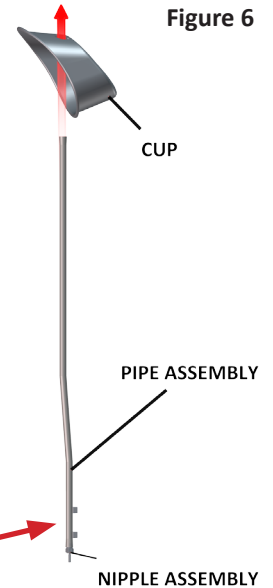
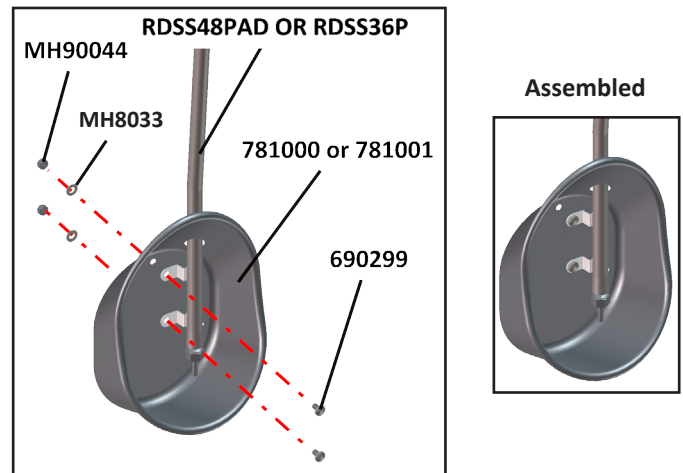
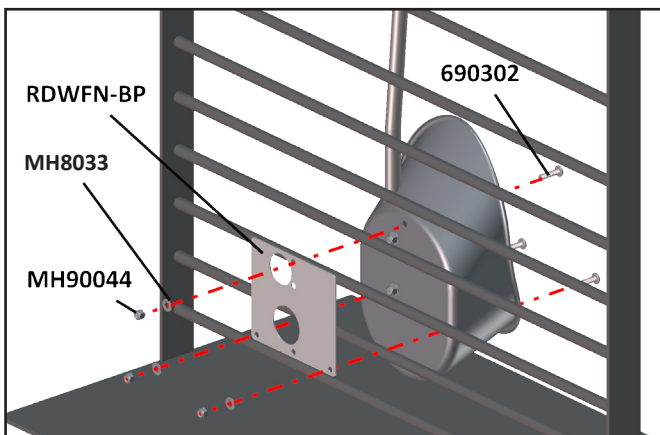

Figure 7



Back to back options for nursery cups MUST have washers/nuts for pipe bracket attachment to the inside of the cup to avoid interference. (This does not pertain to wean to finish applications)

Figure 8 Wean to finish cup Installation



Assembled



INSTALLATION

- If you are using the back to back option, do not use the back plate and mount both cups directly to the gate putting the bolt through both cups, washers and nuts inside the cup, as shown in Figure 9.
- Attach the gate bracket by slipping the pipe into the slot on the gate bracket plate and attach the **#RDZP-N-GB1** (nursery) or **#RDZP-GB1** (wean to finish) gate bracket plate to the angle on top of the gate or to one of the steel rods using **#MH8033** spacer(s) (Optional: sold separately), as shown in Figure 10, 11 & 12 using the **#690307** bolt, (2) **#010424** washer(s), and (2) **#012793** nut(s).

Figure 9 Nursery Cup Installation - both views

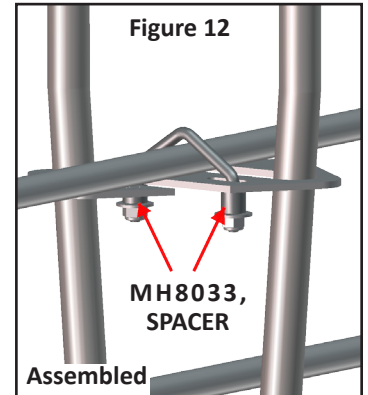
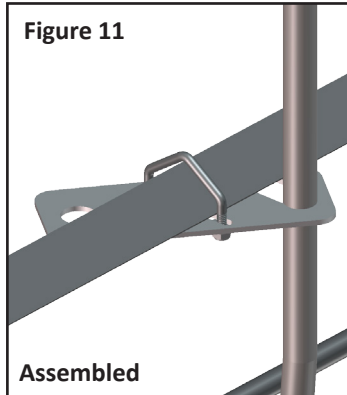
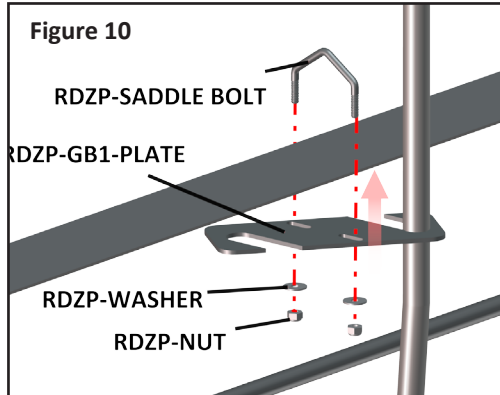
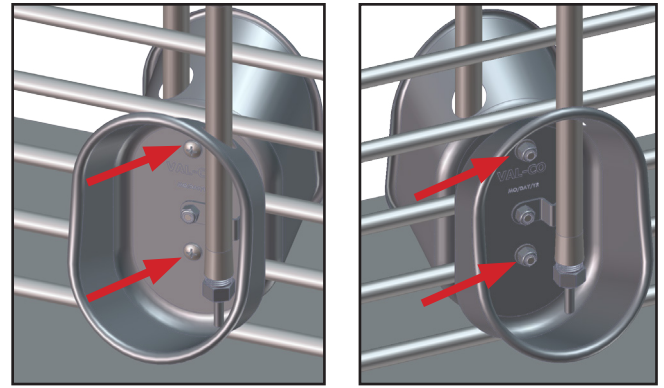

- To attach the **#10092-11** pipe connector shut off saddle, begin by drilling 9/32" hole into the bottom side of the water supply pipe at the appropriate location, *directly above the drinker pipe*.
- Insert the shut off (self-sealing) into the hole you just drilled and clamp securely to the pipe using the bracket and the (2) screws, as shown in Figure 13



(The hose is shipped in 6 foot lengths and may need to be cut to proper length to stretch from the top of the pipe assembly to the water supply line.)

10092-11 PIPE CONNECTOR SHUT OFF SADDLE

Figure 13

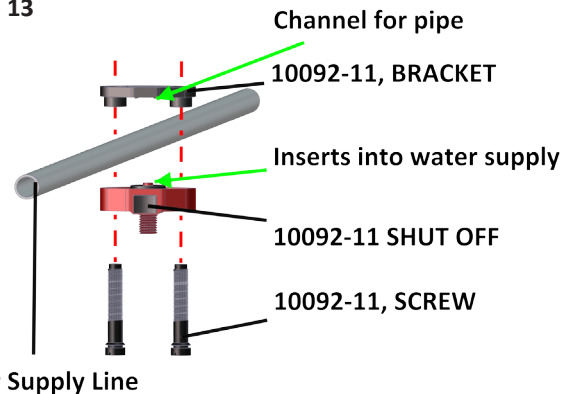

- Slip the (2) clamps onto the hose before you insert the adapters to the ends of the hose, as shown in Figure 14.
- Insert the **#RDWCP04** female adapter into the top end of the **#RDWCP01** hose and the **#RDWCP02** male adapter into the bottom end of the same hose as far in as possible then slide the clamps to each end of the hose leaving approximately 1/8" -1/4" between the clamp and the adapter at each end, as shown in Figures 15 & 16.

Figure 14

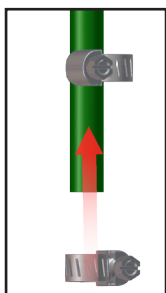

Figure 15

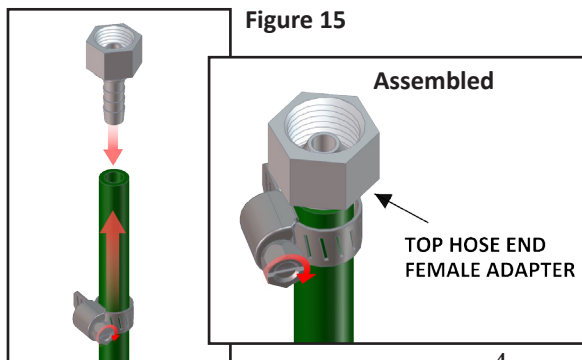
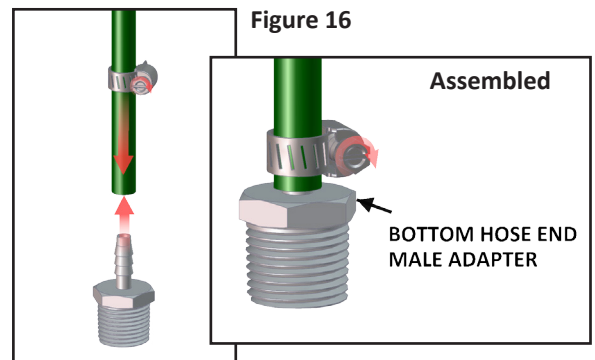

Figure 16



INSTALLATION - continued

10. Connect the #RDWCP-KIT hose, male adapter end, to the drinker pipe *first* then the female adapter end to the pipe connector shut off saddle. This order will keep the hose from twisting. Check fittings for leaks as shown in Figure 17.

Figure 17

Assembled

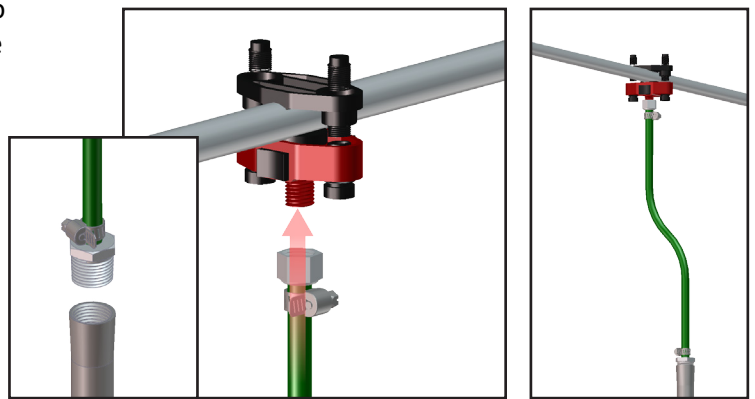

RDWCP-KIT

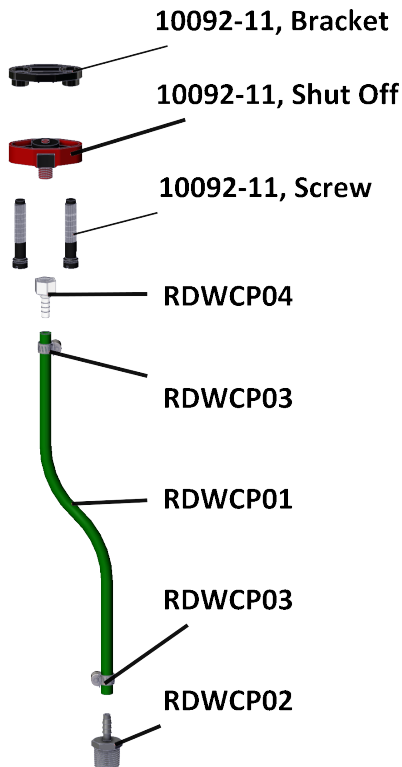

BACKING PLATE

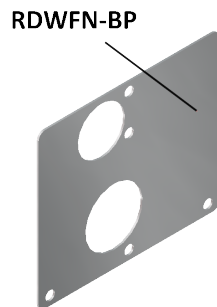

RDZP-GB1 Wean to Finish GATE BRACKET

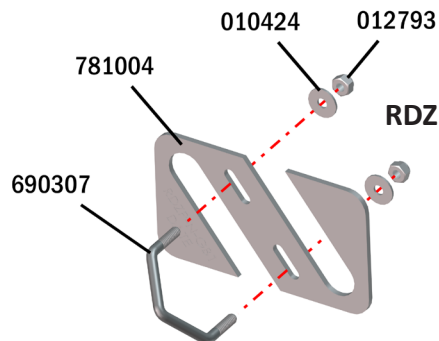
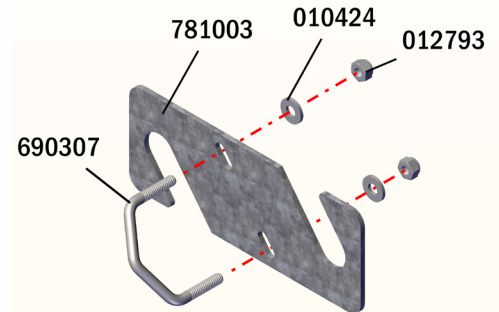

RDZP-N-GB1 Nursery, GATE BRACKET

OPTIONAL SPACER, GATE BRACKET

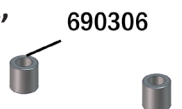

RDNC-KIT-R - EXPLODED

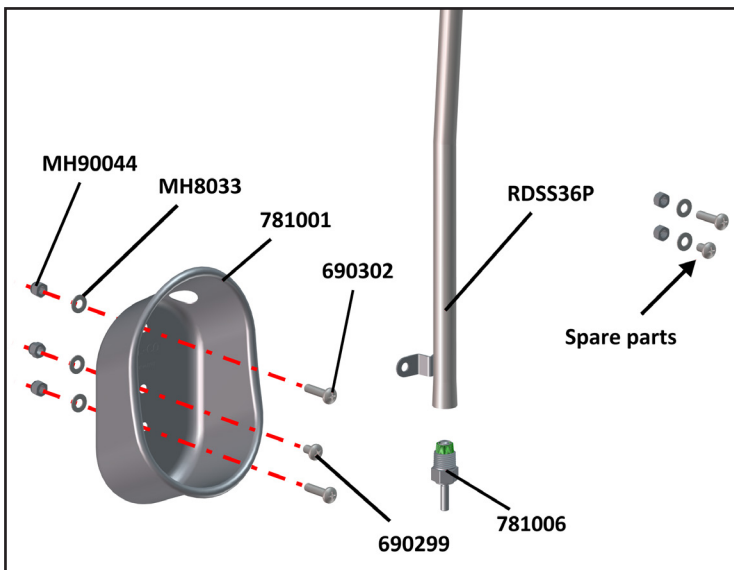

RDWF-KIT-R - EXPLODED

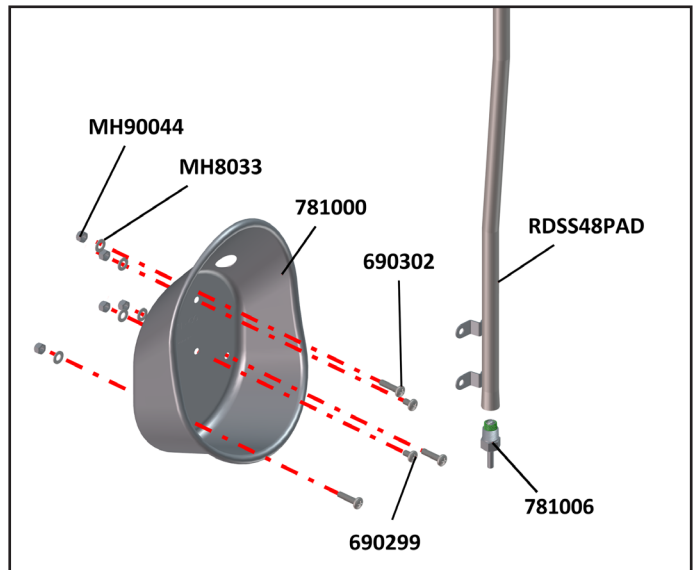

781006 - EXPLODED

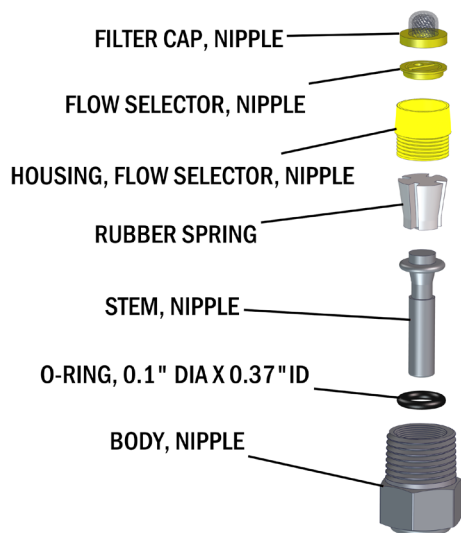

PARTS LIST

PART #	HOG DRINKER - DESCRIPTIONS	QTY
HOG DRINKER CUPS		
781000	CUP, WEAN TO FINISH DRINKER	1
781001	CUP, NURSERY DRINKER	1
HOG DRINKER PIPES		
RDSS36P	PIPE, NURSERY DRINKER	1
RDSS48PAD	PIPE, WEAN TO FINISH DRINKER	1
HOG DRINKER NIPPLE		
781006	NIPPLE, SWINE, RUBBER SPRING	1
HOG DRINKER KITS		
781002	HARDWARE PKG, WF/N CUP KIT	1
RDNC-KIT-R	CUP KIT, NUR/PIPE/NIP/HRDW PKG	1
RDWF-KIT-R	CUP KIT, WF/PIPE/NIP/HRDW PKG	1
HOG DRINKER ACCESSORIES (NOT included in Kits)		
690306	GATE BRACKET SPACER, (Optional)	1
RDWCP-KIT	DRINKER PIPE PLUMBING KIT	1
RDWFN-BP	BACK PLATE, SWINE DRINKER CUP	1
RDZP-GB1	GATE BRACKET KIT, WF PIPE	1
RDZP-N-GB1	GATE BRACKET KIT, NUR PIPE	1
HOG DRINKER REPLACEMENT PARTS		
RDWCNP-01-2-S	SPRING, SWINE NIPPLE, STEEL	1
RDWCNP-01-4-S	SPRING, SWINE NIPPLE, RUBBER	1

PART #	KIT - DESCRIPTIONS	QTY
781002 (HARDWARE PKG, WF/N CUP KIT)		
690299	5/16-18 X 1/2 SS SCREW	2
690302	5/16-18 X 1-1/4 SS SCREW	3
MH8033	11/32 X 11/16 SS FLAT WASHER	5
MH90044	5/16-18 SS NYLOCK NUT	5
RDNC-KIT-R (CUP KIT, NUR/PIPE/NIP/HRDW PKG)		
781001	CUP, NURSERY DRINKER	1
781002	HARDWARE PKG, WF/N CUP KIT	1
781006	NIPPLE, SWINE, RUBBER SPRING	1
RDSS36P	PIPE, NURSERY DRINKER	1
RDWF-KIT-R (CUP KIT, WF/PIPE/NIP/HRDW PKG)		
781000	CUP, WEAN TO FINISH DRINKER	1
781002	HARDWARE PKG, WF/N CUP KIT	1
781006	NIPPLE, SWINE, RUBBER SPRING	1
RDSS48PAD	PIPE, WEAN TO FINISH DRINKER	1
PART # HOG DRINKER ACCESSORIES QTY		
RDWCP-KIT (DRINKER PIPE PLUMBING KIT)		
10092-11	PIPE CONNECTOR SHUTOFF SADDLE	1
IS10029	ASSEMBLY INSTRUCTIONS	1
RDWCP01	HOSE, 1/4" X 6' GREEN PVC	1
RDWCP02	ADAPTER, 1/4BARB-1/2MALE NPT	1
RDWCP03	CLAMP, WORM DRIVE 10-16 MM	2
RDWCP04	ADAPTER, 1/4BARB-1/4FEMALE NPT	1
ZB1403	BAG, 9" X 12"	1
RDZP-GB1 (GATE BRACKET KIT, WF PIPE)		
010424	1/4" FLAT WASHER	2
010768	BAG, 5" X 9"	1
012793	1/4-20 NYLOCK NUT	2
690307	V-BOLT, .25-20, 2.125W, 1.75H	1
781003	GATE BRACKET, WEAN TO FINISH	1
RDZP-N-GB1 (GATE BRACKET KIT, NUR PIPE)		
010424	1/4" FLAT WASHER	2
010764	BAG, 4" X 8"	1
012793	1/4-20 NYLOCK NUT	2
690307	V-BOLT, .25-20, 2.125W, 1.75H	1
781004	GATE BRACKET, NURSERY	1

North America:

Phone: 800.99VALCO (800.998.2526)

Fax: 419.678.2200

Email: sales@val-co.com

990046

TRC (REV. 2) 4-26-2018

International:

Phone: (+1) 419.678.8731

Fax: (+1) 419.678.2200

Email: intl.sales@val-co.com