



Quick Sheet Instructions

Turkey Bell Drinker

VTB105

Assembly Instructions

The Val-Co® VTB105 are shipped as sub-assemblies and will require some assembly. Refer to page 2, Exploded drawing, for a view of each assembly and available replacement parts.



1. Assemble the Valve Assembly to the Turkey Bell Bowl Assembly. Screw the threads of the Bowl Adapter into the threads of the Collar 1-3 turns to hold the bowl securely, as shown in Figure 1.

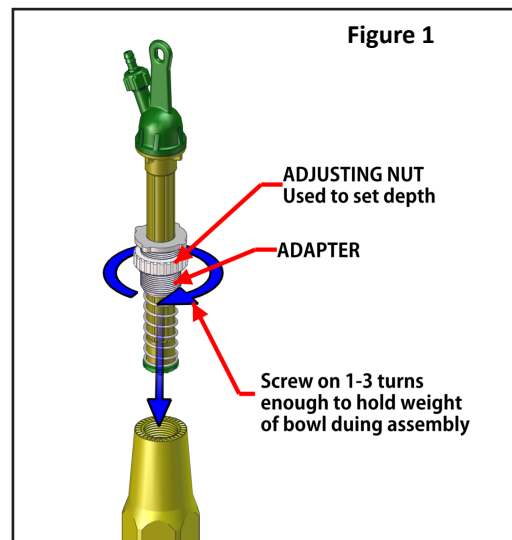

Be sure the Adjuster Nut is on the Bowl Adapter and screwed into the top of the Bowl Adapter by at least (1) one thread but not more than (3) three threads.

2. Assemble the water supply Saddle/Tubing, as shown in Figure 2, 3 and 4.
3. Hang in place using the VTB170 Clip, VD319 Rope and the VS341 Height Adjustment Strap, as shown in Figure 5. (Clip & Height Adjustment detail on next page.)
4. Turn the water to the drinker on.

Figure 2

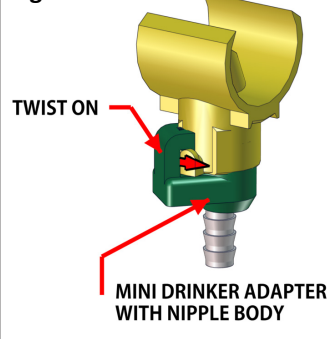
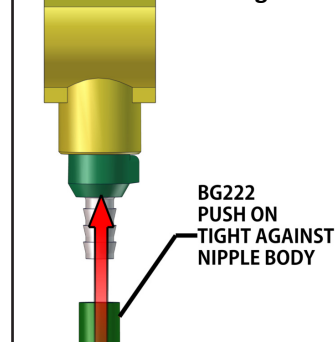

Figure 3



There should be little to no water coming from the trigger valve.

WATER FLOW ADJUSTMENT

5. Gently spin the bowl up while holding the adjusting nut until water starts running from the valve.
 - a. If the water stops running too quickly (water level below ½"), screw the bowl up slightly (probably less than ½ turn).
 - b. If the water does not stop running soon enough (water level above 1 ¼"), screw the bowl down slightly (probably less than ½ turn).
6. Once the desired water level is achieved carefully tighten the green lock nut without changing the relationship between the bowl adapter and the adjusting nut.

Figure 4

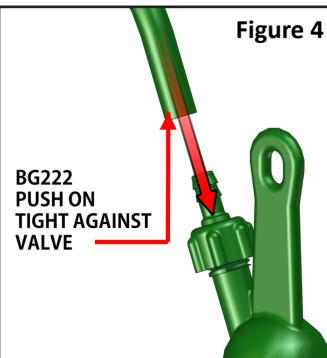
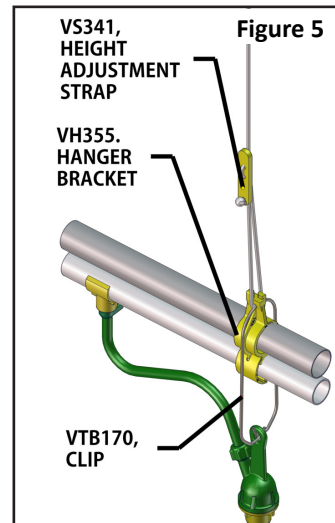
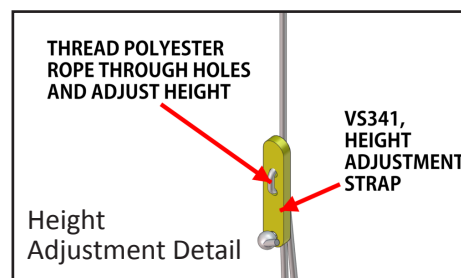
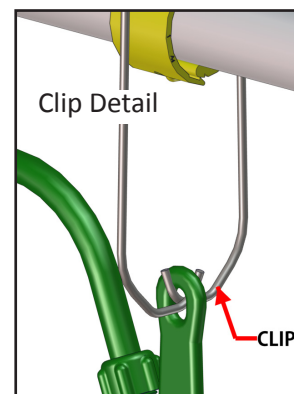
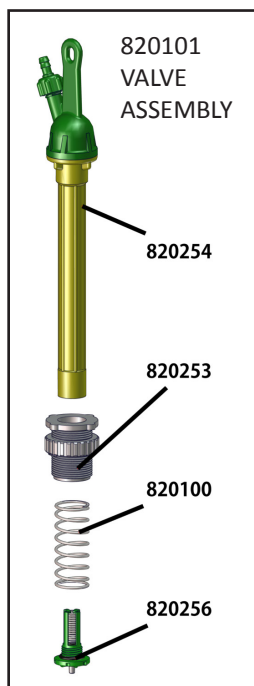
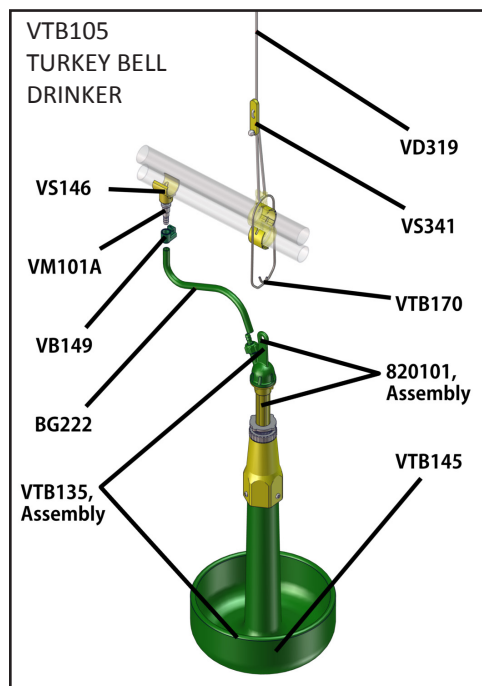

Figure 5



7. Future adjustment, should they be needed, are accomplished in a similar manner as step 5; if a slight adjustment is needed steps 5.a. or 5.b. should provide the desired results while a larger adjustment would warrant starting at the beginning of step 5.

VTB105 ASSEMBLIES



PART #	DESCRIPTION	QTY
VTB105 TURKEY BELL DRINKER		
BG222	GREEN PVC TUBING 1/4"	1.5
VD319	CORD, 1/8", POLYESTER, SOLID BRAID, NATURAL	2
VM101	MINI DRINKER ADAPTER WITH NIPPLE BODY	1
VS341	HEIGHT ADJUSTMENT STRAP	1
VTB135	FLANGLSS TURKEY BELL BOWL & VALVE ASSMBLY	1
VTB170	TURKEY BELL CLIP 304 SS	1
VTB135 TURKEY BELL DRINKER, BOWL AND VALVE ASSEMBLY		
VTB145	TURKEY BELL BOWL ASSY W/O FLANGE	1
820101	TURKEY BELL DRINKER VALVE ASSEMBLY	1
820101 - TURKEY BELL DRINKER VALVE ASSEMBLY		
820100	SPRING, COMP, SS, 1.017" OD 2.464" LG, .072 DIA, 302SS	1
820253	TURKEY BELL VALVE, ADJ NUT ASSY	1
820254	TURKEY BELL VALVE, STEM ASSY	1
820256	TURKEY BELL DRINKER, TRIGGER PIN ASSY, CL RESISTANT	1
ACCESSORY		
VS146	SADDLE STANDARD	1

North America:

Phone: 800.99VALCO (800.998.2526)

Fax: 419.678.2200

Email: sales@val-co.com

U:\MANUALS\990000\990014
JDS 7-9-2014 (REV 1)

©2014 Valco Companies, Inc.

International:

Phone: (+1) 419.678.8731

Fax: (+1) 419.678.2200

Email: intl.sales@val-co.com