

4" Polypropylene Egg Belt Take-Up Kit & Belt Instruction

412539

Quick Sheet

Installing the Take-Up

The Take-up is pre-assembled and is easily attached to the Egg Collector.

1. Begin by placing the Take-Up assembly at the proper location toward the back of Egg Collector Table. (If this is a retro-fit installation you will need to disconnect the table from the Trough Covers and pull away from the wall to allow room for the Take-Up.)
2. Remove the lower Roller Shaft. It will not be used due to interference with the belt when using the Take-Up kit. Use the 5/16 Hex bolts, lock washers and nuts included with hardware bag to secure the bottom hole of the Take-Up (bracket) to the hole of the removed lower shaft.
3. If necessary shorten or lengthen the Take-Up by loosening 010424 nuts on covers and slide up or down either direction as required for correct height, Figure 2. Do this to both sides (front and back) of Take-Up. When finished the guards MUST be resting on the floor.

Figure 1

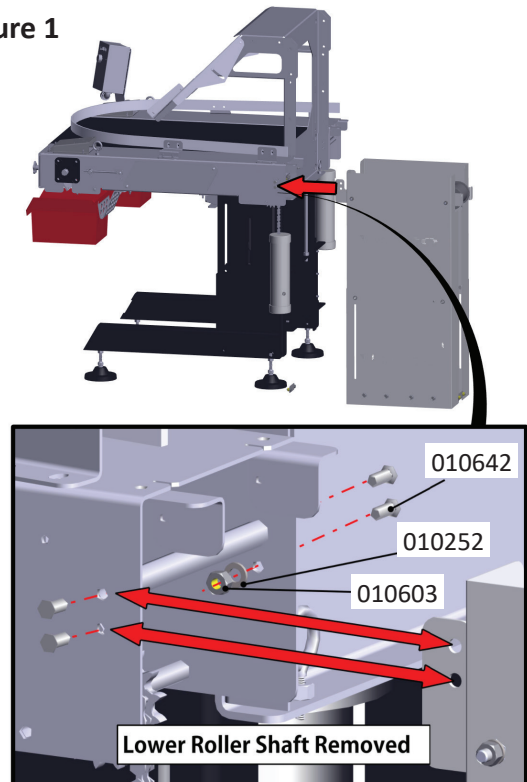
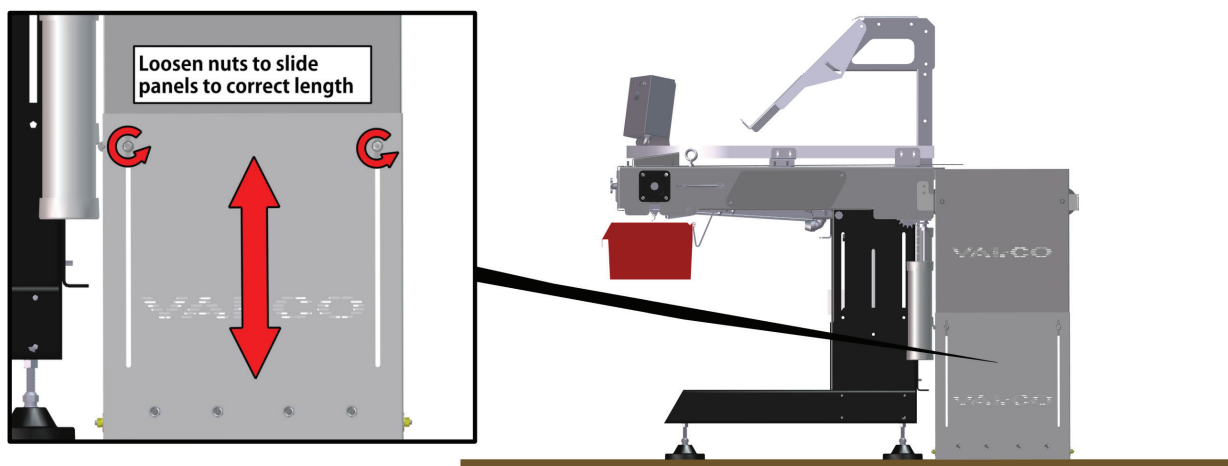

Figure 2



Extending the Take-Up

Extra panels are included with kits for additional lengthening.

4. To extend panels remove the top 010603 nuts and 010252 lock washers to release the Take-Up at top covers from the Roller Bracket. Attach Extension Panels to each side of Roller Bracket using same hardware. Now attach the Take-up, at top of covers, to Extension Panels. Match panel holes and use hardware included with 412554 hardware bag. **THIS STEP MAY BE PERFORMED AFTER THE BELT IS THREADED OR YOU MAY LEAVE THE TOP FRONT COVER OF THE EXTENDED OR NON-EXTENDED TAKE-UP UNTIL AFTER THE BELT IS THREADED.**

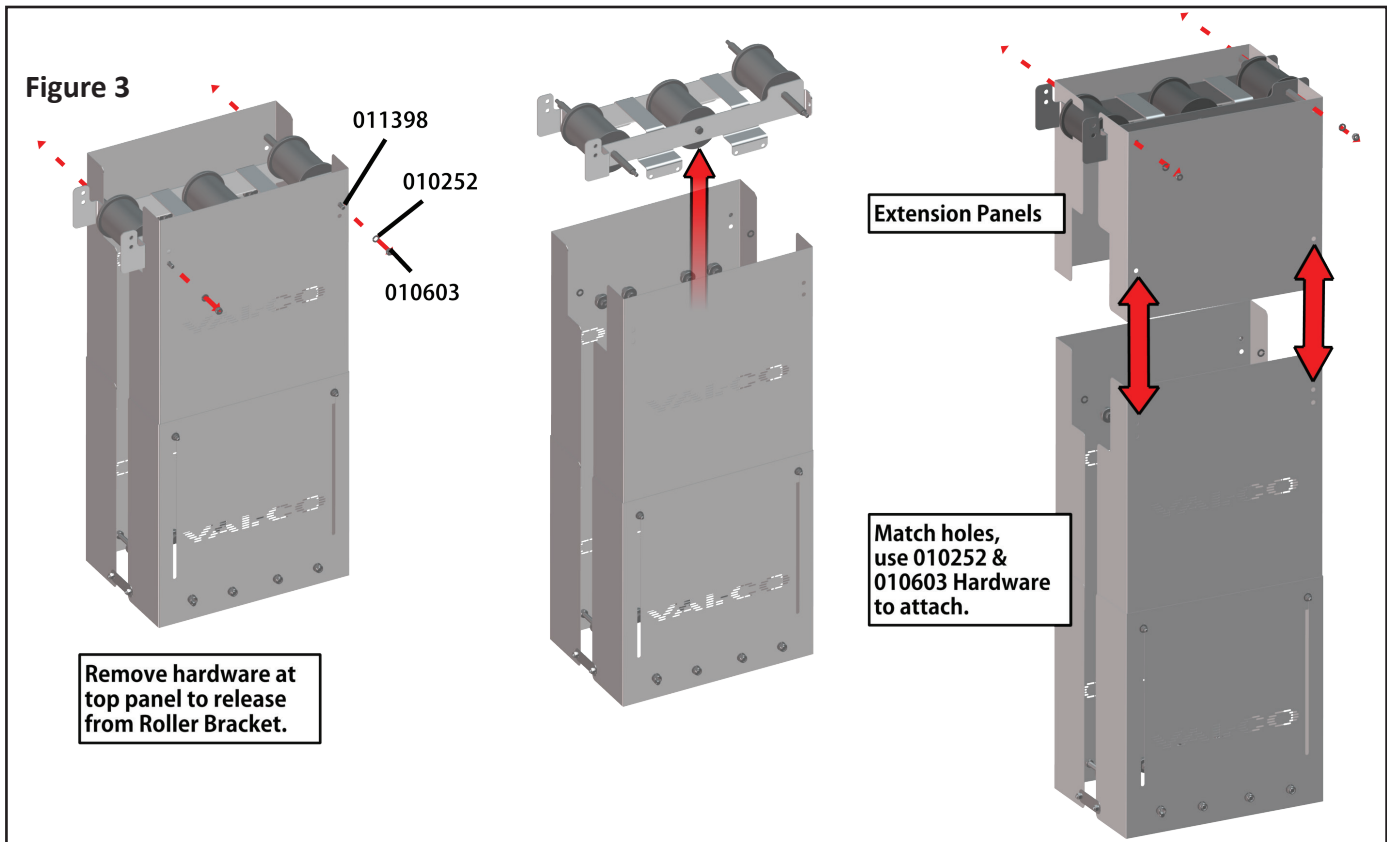

Installing the Connector Trough Covers

5. Before the belt is threaded, add Trough Covers, which are included in the Take-Up kit. Retro fit installations may need additional Trough Covers to make up for the added distance. If this is a retro-fit install you will need to detach the Trough Cover from the table and pull the table away from wall to allow room for the Take-up. Attach the 412070 Trough Covers at the Egg Collector, shown in Figure 4. Use 012795 bolts and 012408 nuts to connect to table. (This hardware is included with the nest assembly.) Then attach to existing Trough Covers using rivets also included in the Take-Up kit. **THREAD THE BELT THROUGH THE TROUGH COVERS AND THROUGHOUT THE NESTS.**

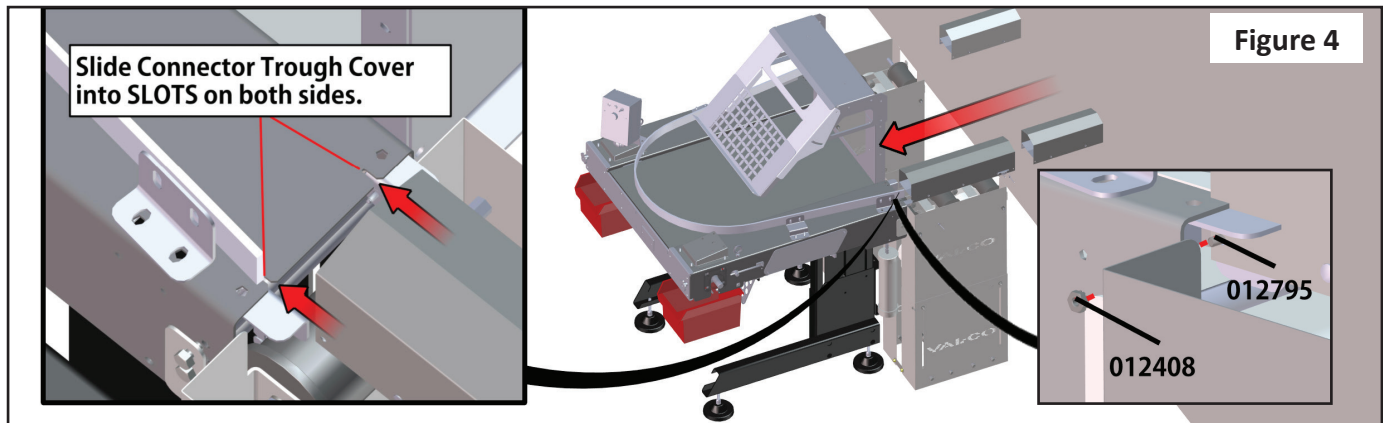

Installing the Polypropylene Egg Belt

- Open the roll of Polypropylene Egg Belt and trim the end in an arrow form with a straight edge at the center of the end.

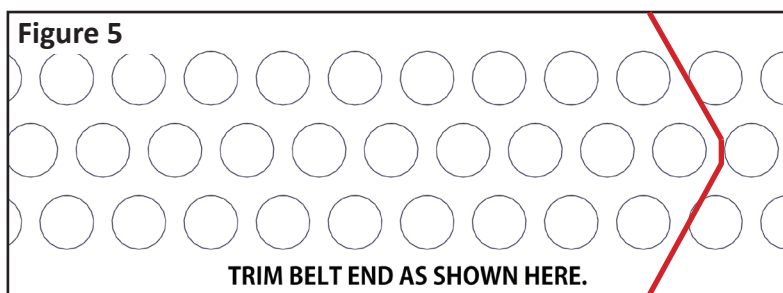

Leave some edge around holes then discard trimmed edge piece.

- Remove the side panel on the Egg Collector Housing and the top cover on the Take-Up.

Threading the Egg Belt

- Thread belt with both weights installed as shown in Figure 6 for Table End belt threading. Continue threading as detailed on the next page step 9.



If belt is installed at warm temperatures such as 80 DEGREES OR WARMER, the belt may contract enough to become tight if the temperature in the barn becomes much lower. The take ups **MUST** be checked periodically to know where the weights are. If they are at the top during colder temperatures, the belt may need lengthened by adding a section of belt, **BUT NOT AT THE ORIGINAL JOINT**.

Figure 6

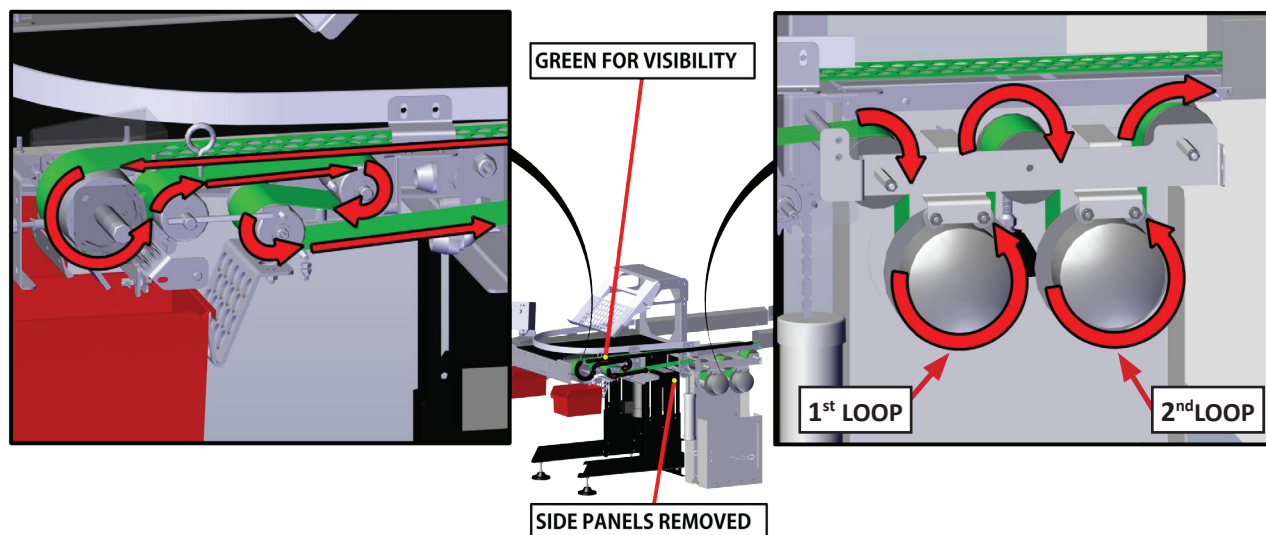

9. After threading the polypropylene belt through the Egg Collector Table, Take-Up and pulling through Nest Trough Assemblies, now thread through the End Belt Return as shown in Figure 7 and pull the belt end back through to the other belt end at the Egg Collector table. Clamp belt ends into place and tighten belt so that both weights are at the top bearings. Connecting, trimming, lacing and securing the belt are detailed below and on the next page.

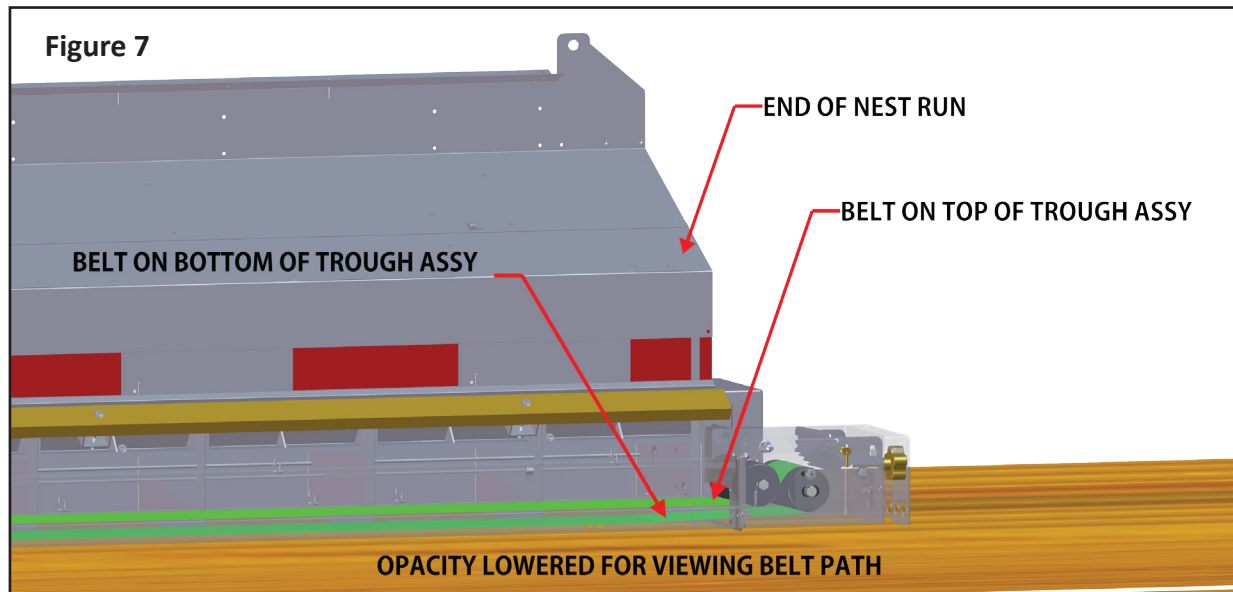

Connect the Belt Ends

10. After you have completely threaded the belt, BE SURE YOU HAVE ALLOWED ENOUGH BELT FOR THE 2 LOOPS AT THE TAKE-UP, as shown in Figure 6 of the previous page. Trim this belt end in the same manner as instructed in Step 6, Figure 5 on page 3. Overlap the ends by 8-9 holes (at the side of the belt). **MAKE SURE THE TOP BELT IS POINTING AT THE NEST.** When overlapping the holes make sure they are not directly above each other, they should be staggered, shown in Figure 8.

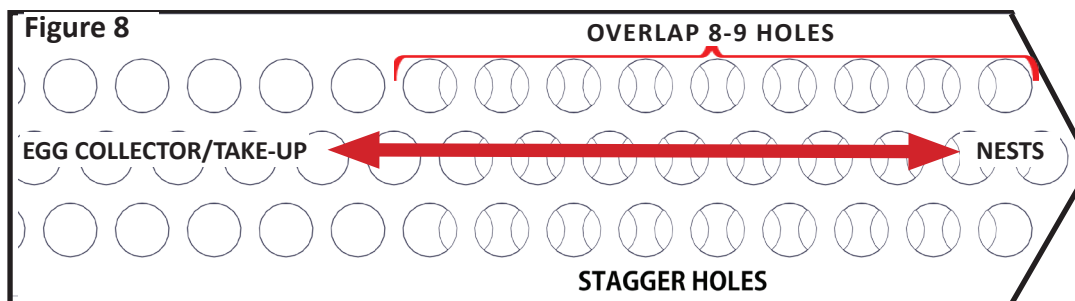

Belt Lacing

11. Cut (6) pieces of belt strapping to a length of approximately 28" for use to weave through the belts. Fold each piece of strapping in half, thread each strap through the belt by placing the fold into a belt hole, 1 hole before the overlap. Then weave each half of each strap in and out of each belt hole opening, so that the strapping is doubled or double thickness, shown in Figure 9.

Figure 9

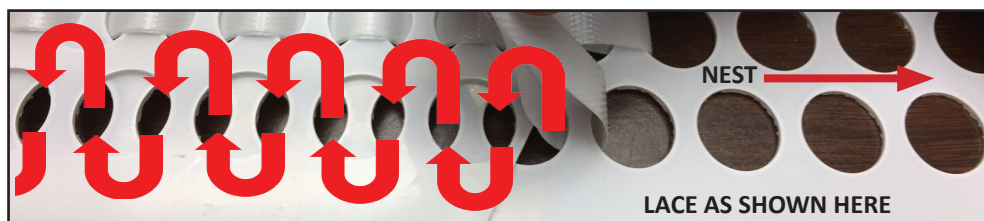

Securing the Belt Lacing

12. After all 3 rows of holes have been laced, drill small holes at both sides of the belt through each overlapped end and in the single layer of belt, circled in red below. Then use thread through each hole to secure the edges of the belt ends tightly.

Figure 10

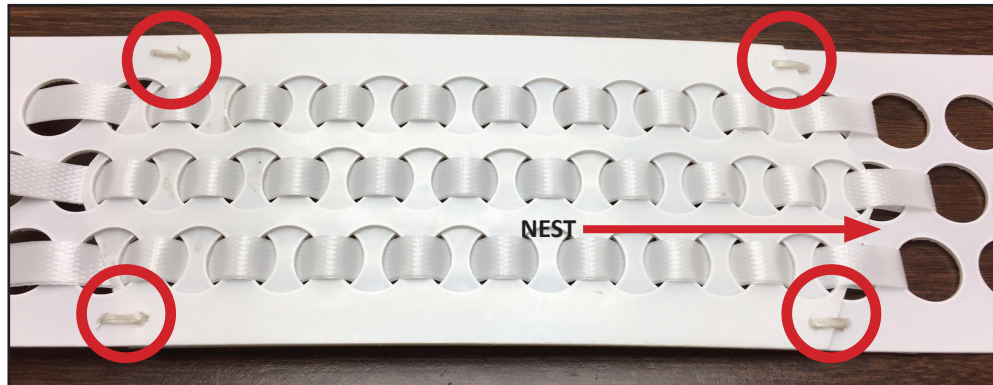

Counterweight Detail

13. Pull belt tight until the counterweight is 2-3 links below sprocket.

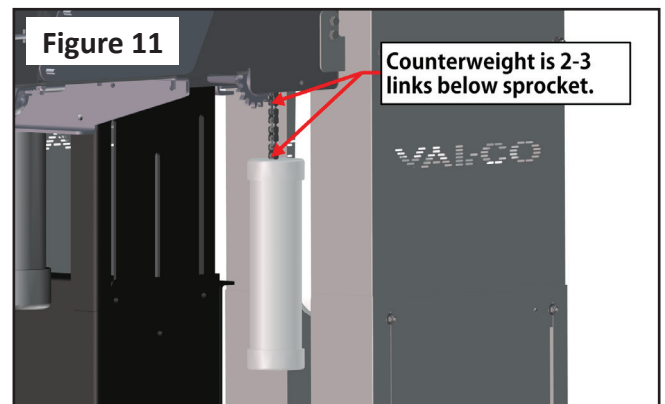

Exploded View - Take-Up Kit

412540 Assembly

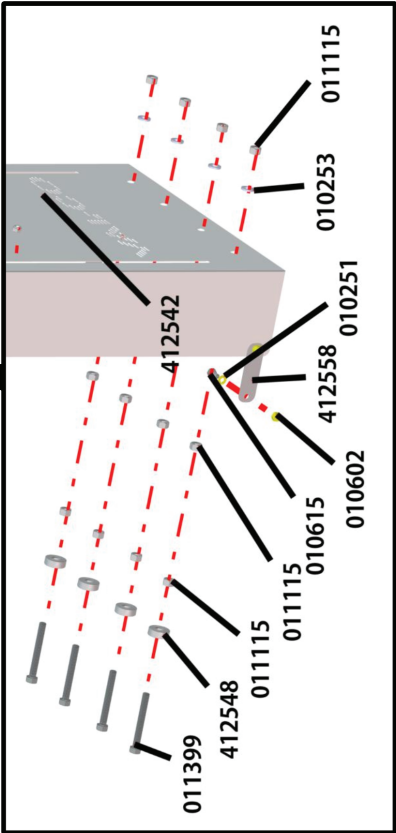
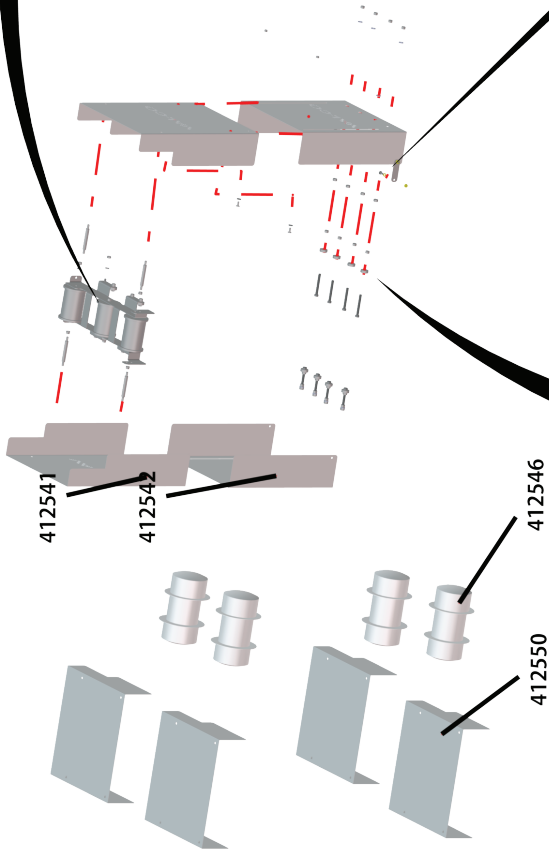
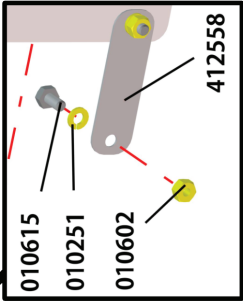
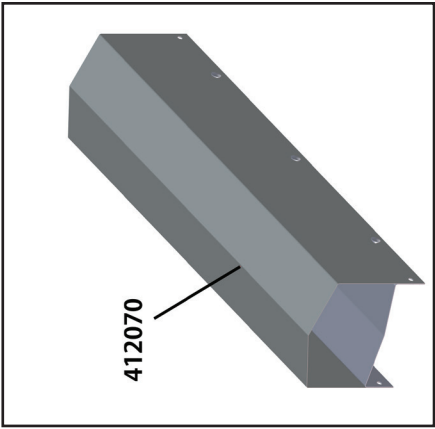
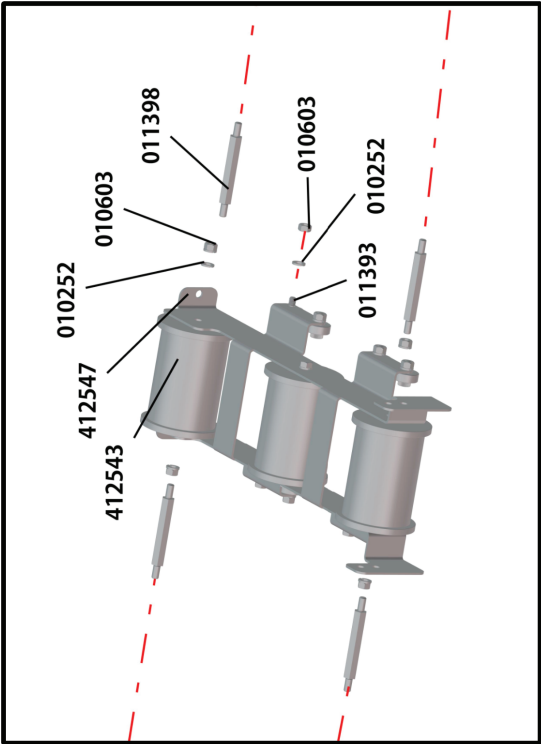

PARTS LIST

PART #	DESCRIPTION	QTY
412539 *Some parts in gray are available for replacement		
412070	18" CONN TROUGH/COVER	2
412540	ASSY, TAKE UP, POLY BELT, 4"	2
010251	WASHER, LOCK 1/4" MED SPLIT ZP	4
010252	WASHER, LOCK 5/16" MED SPLIT ZP	18
010253	WASHER, LOCK 3/8", MED SPLIT ZP	8
010424	WASHER, FLAT, 1/4" SAE ZP	4
010602	NUT, HEX 1/4"-20 A FINISHED ZP	4
010603	5/16" FINISHED FULL NUT	12
010615	1/4-20 X 1/2" HEX BOLT	4
010643	5/16-18 X 3/4" HEX BOLT	2
011115	NUT, HEX 3/8-16" A FINISHED ZP	24
011393	BOLT, SHOULDERM .375 X .375	8
011398	STANDOFF, .500 X 3", 5/16-18 MALE/MALE	4
011399	BOLT, HEX, 3/8-16 X 3, ZP FULL THREAD	8
012793	1/4-20 NYLOCK NUT	4
412541	GUARD ASSY, TAKE UP, UPPER 4"	2
412542	GUARD, TAKE UP, LOWER	2
412543	PULLEY, 3.5 X 4.69	3
412544	SHAFT, PULLEY, .625 X 4.78	3
412547	BRACKET, TAKE UP, 4"	1
412548	BEARING, .375 X 1.125, SHIELD	16
412558	PLATE, CONNECTOR, GUARD	2
412546	WEIGHT, TAKE UP, SIDE BELT	4
412552	TUBE, WEIGHT, 4.5 X 8.38, PVC	1
412556	CAP, PVC, 4"	2
412557	PLATE, GUIDE, BELT	2
770021	MISC. STEEL SLUGS	20
412550	GUARD EXTENSION, TAKE UP, BELT 4"	4
412554	HARDWARE BAG, TAKE UP, 4"	1
010252	WASHER, LOCK 5/16" MED SPLIT ZP	8
010603	5/16" FINISHED FULL NUT	8
010640	BOLT, HEX HEAD, 5/16-18 X 1/2" ZP (not shown)	4
012802	RIVET, POP #62X3/16" ALL-ALUM (not shown)	4

North America:

Phone: 800.99VALCO
(800.998.2526)
Fax: 419.678.2200
Email: sales@val-co.com

990166
9-20-2017

International:

Phone: (+1) 419.678.8731
Fax: (+1) 419.678.2200
Email: intl.sales@val-co.com