



# Quick Sheet Instructions

## 150LB POLY HOPPER KIT

### Installation Instructions (for 451330):

#### STEP 1:

Place truss bolts through the remaining holes in the cone. Ensure bolt heads are inside the cone.

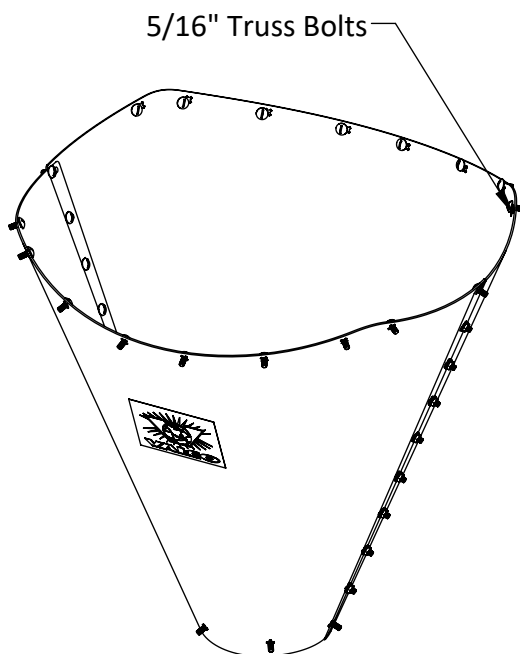
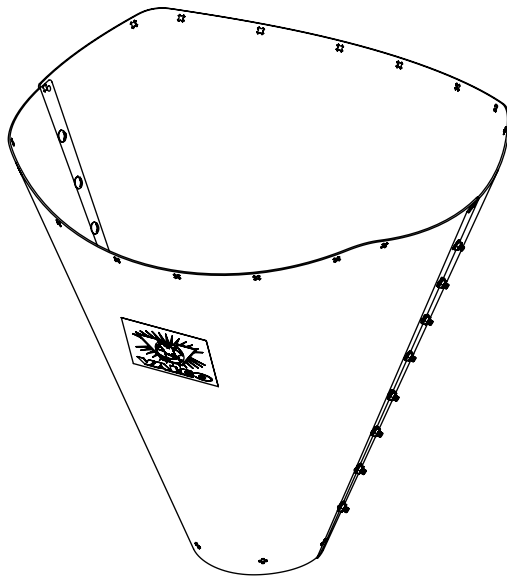

### Installation Instructions (for 451350):

#### STEP 1:

Position (2) panels such that the VAL-CO labels are face up.

Install truss bolts as shown.

Fasten Panels together along the edge containing empty holes.

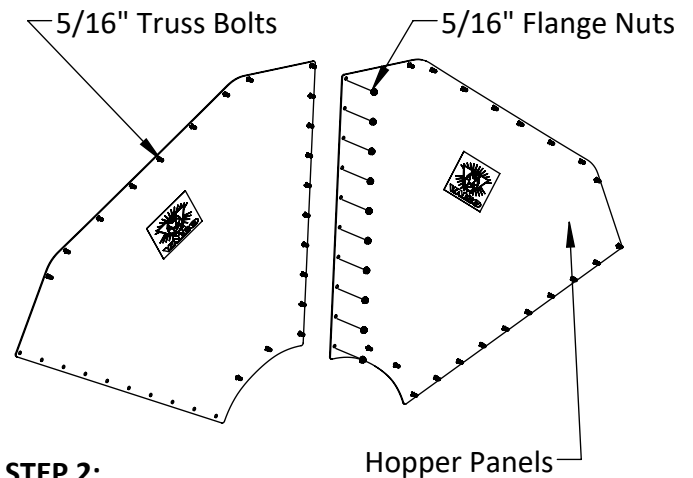

#### STEP 2:

Bend panels back on themselves such that the bolt heads are facing inside the cone.

Starting one from the top, fasten the free ends to each other using the provided hardware.

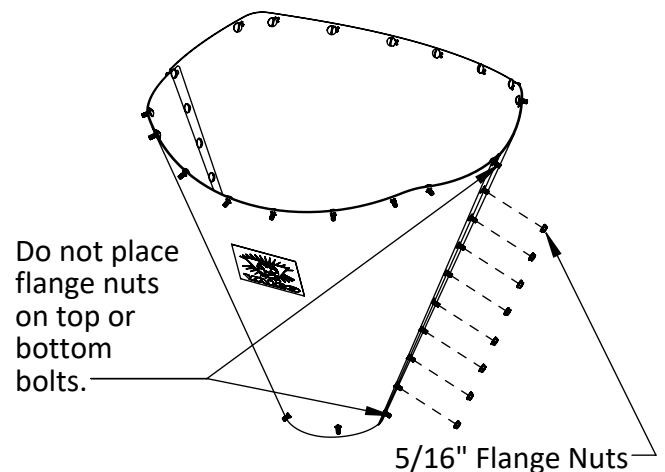

## Installation Instructions (continued):

### STEP 3:

Install Brackets to top of hopper as shown on the right.

Begin by installing the hardware in the *middle* of the Brackets and work your way to the ends.

Ensure Short Brackets are installed on the sides where the seams are formed.

Ensure Cable Retaining Brackets are installed on the outside of the Long Brackets.

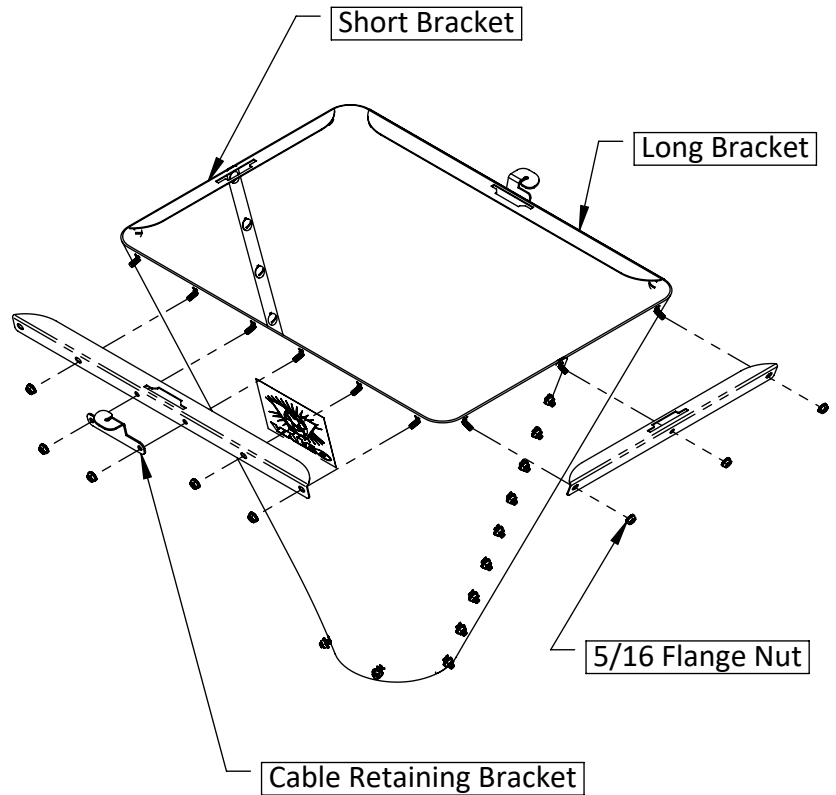

### STEP 4:

Fasten Collar to the bottom of the Hopper Assembly.

Ensure that the notch in the Collar is aligned with the seam in the Hopper Assembly.

Install Crossbrace by dropping it into the slots found on the top surface of the Long Brackets.

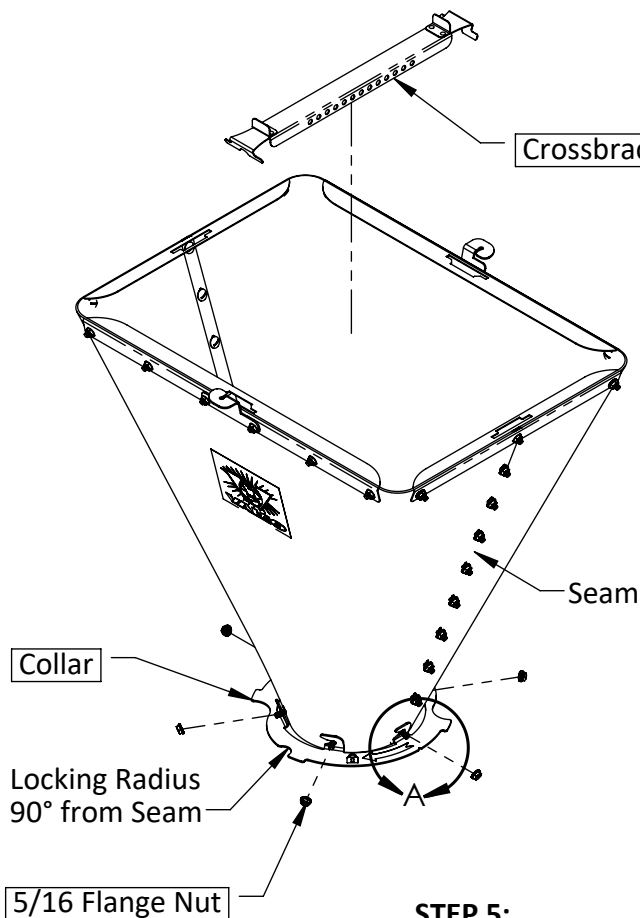
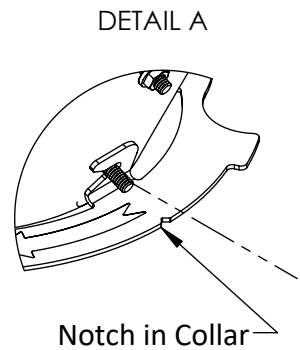

### STEP 5:

Drop Base Assembly into the slots present on the top of the Boot Assembly.

Use hardware to secure them together as shown on the right.

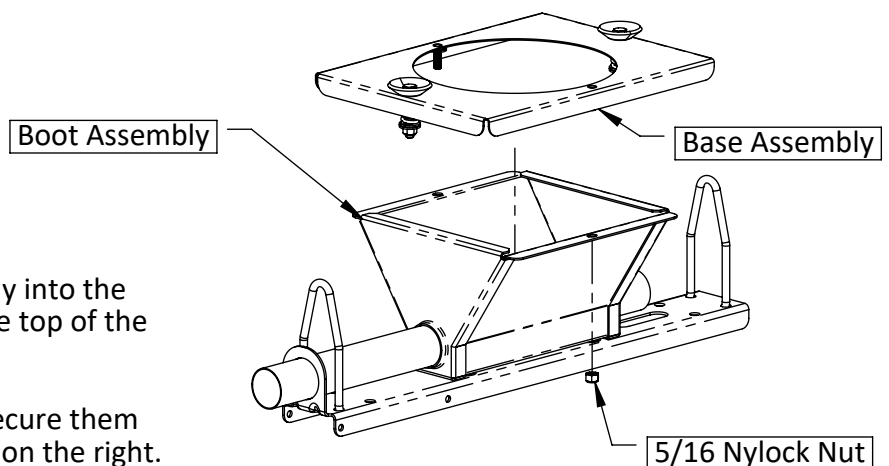

## North America:

Phone: 800.99VALCO (800.998.2526)  
Fax: 419.678.2200  
Email: sales@val-co.com

990293 [A] 1/5/2023  
Page 2

## International:

Phone: (+1) 419.678.8731  
Fax: (+1) 419.678.2200  
Email: intl.sales@val-co.com

## Installation Instructions (continued):

### PARTS LIST:

| Item No.  | Part No. | Description                | Qty |
|---|----------|----------------------------|-----|
| <b>451330/451350 - LIGHTWEIGHT HOPPER, 150 LB</b> |          |                            |     |
| 1   | 451333   | COLLAR, LW HOPPER          | 1   |
| 2   | 451335   | BASE ASSY, LW HOPPER       | 1   |
| 3   | 451336   | LONG BRACKET, LWH, TOP     | 2   |
| 4   | 451337   | SHORT BRACKET, LWH, TOP    | 2   |
| 5   | 451340   | PANEL & HW ASSY, LW HOPPER | 2   |
| 6   | 451342   | CROSS BRACE ASSY, LWH      | 1   |
| 7   | 451344   | CABLE RETAINER, LW HOPPER  | 2   |

NOTE: 451343 HARDWARE BAG NOT SHOWN

### FINAL STEP:

Place Lightweight Hopper onto the Base Assembly at a 45° angle.

Turn clockwise until a positive lock is felt, as illustrated on the right.

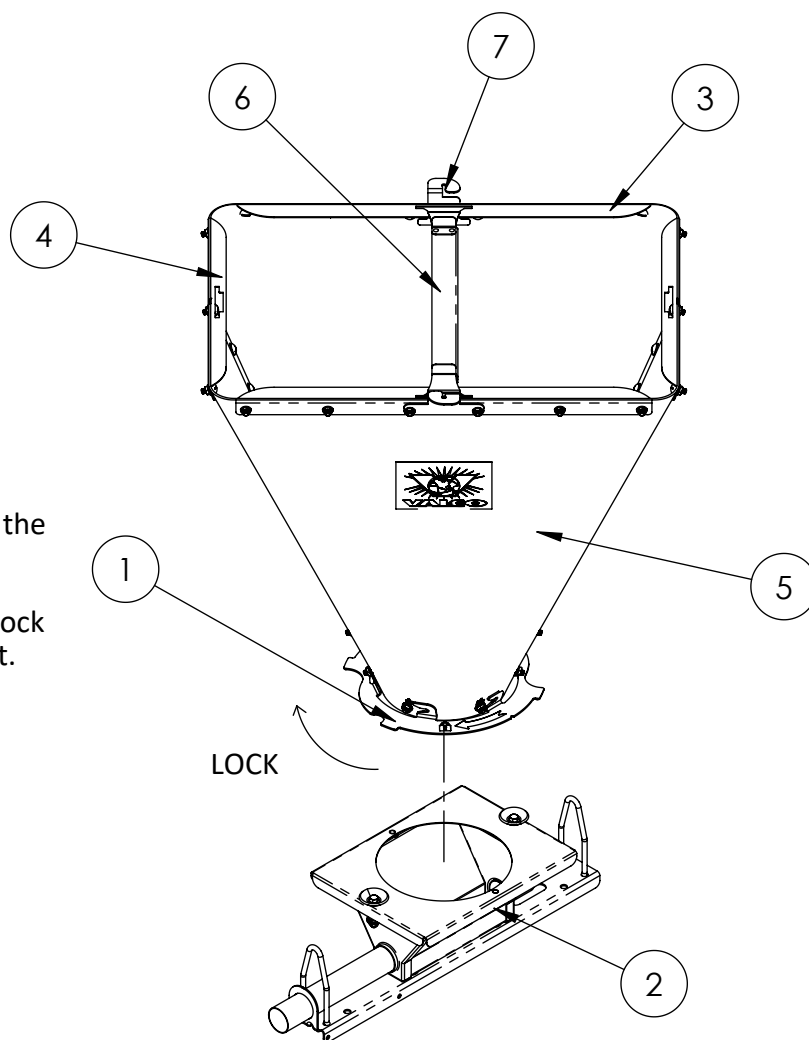

### North America:

Phone: 800.99VALCO (800.998.2526)

Fax: 419.678.2200

Email: sales@val-co.com

990293 [A] 1/5/2023

Page 3

### International:

Phone: (+1) 419.678.8731

Fax: (+1) 419.678.2200

Email: intl.sales@val-co.com