



Quick Sheet Instructions

15 Degree Wedge Installation
7.5 Degree Wedge Installation

Part Number:

501470 - 15 Degree Wedge Assembly

501480 - 7.5 Degree Wedge Assembly

Table of Contents:

Page 1 - Overview, Orientation, and Stacking

Page 2 - Caulking Instructions & Parts list

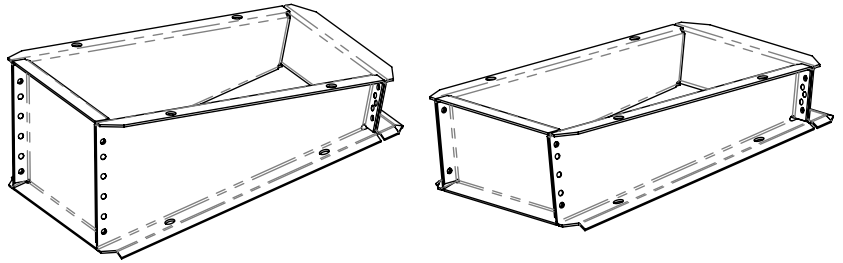

Overview:

This Quick Sheet Instruction will aid in the installation of a 15 & 7.5 Degree Wedge to the lower boot (single or twin) and the Slide Valve. The 15 & 7.5 degree wedge can be used in combination with a straight, double, or 30 Degree transition.

Orientation:

Orientation of the Wedge is critical to avoid re-caulking. Note that the Wedge should be positioned so the bearing end of the boot tilts down, while the pipe end tilts up, as shown in **Figure 1**. Be sure the slide valve is oriented correctly as per the Slide Valve Installation in the Flexible Auger Manual.

Figure 1:

45° outlet angle shown

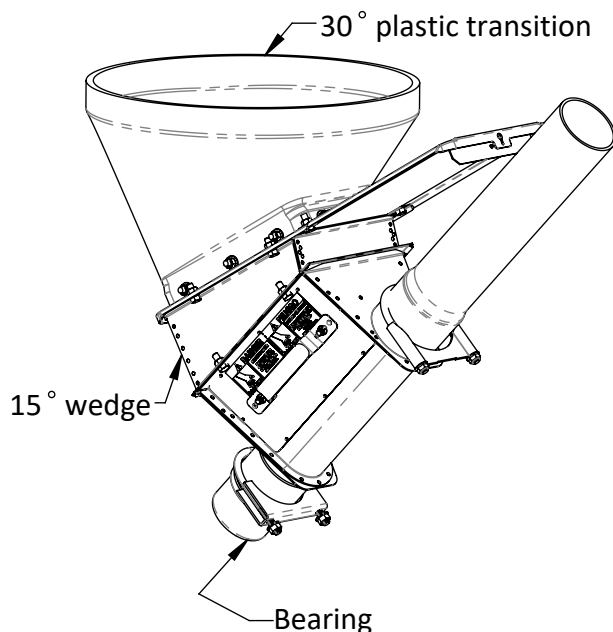

Stacking Wedges:

It is NOT recommended to bolt two 15 degree wedges on top of each other in order to obtain a 30 degree angle. Standard height of feed bin and two stacked 15 degree wedges will not allow for enough room to fit bearing shaft and auger into the back end of the boot. **Attempting to force the bearing shaft and auger in the boot could result in auger kinking and can prematurely wear the boot or pipe, as shown in Figure 2.**

Figure 2

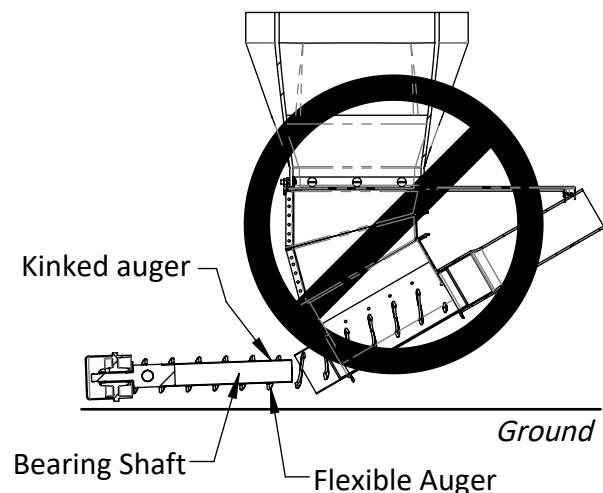

Caulking Instructions:

To ensure moisture does not seep inside the boot, properly caulk the locations shown in **Figure 3**.

- Be sure to clean locations where caulking is to be applied.
- Use UV resistant silicone caulk.
- Fill holes of the wedge with caulk.

Reference the Slide Valve & Hardware Installation section of the Flexible Auger Feed Delivery System Installation & Operator's Manual for more information on caulking for the transition to the slide valve and the bearing and piping with regards to the lower boot.

Figure 3

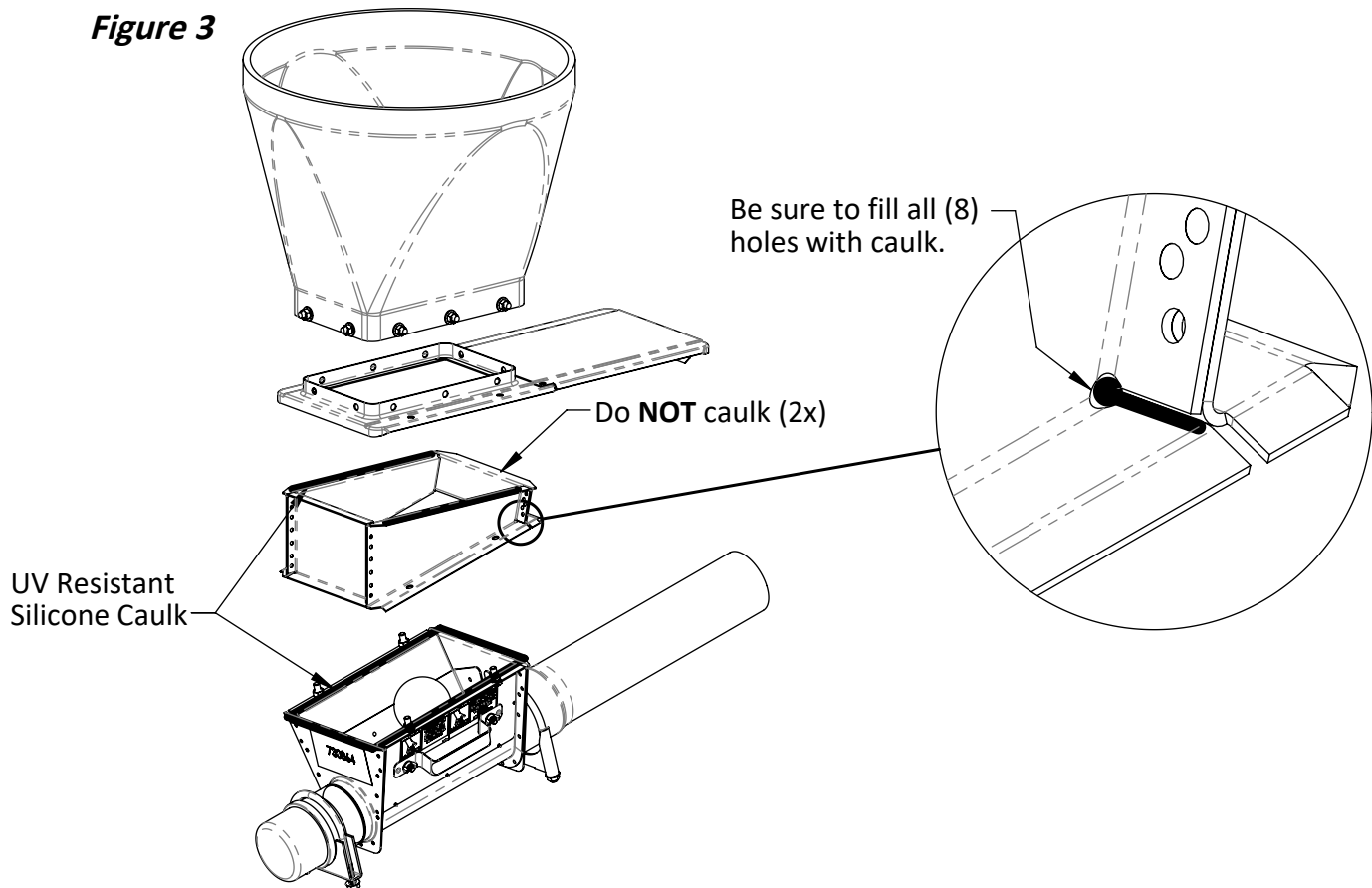

Parts List: 15 Degree Wedge

Item No.	Part No.	Description	Qty
501470 Components			
1	501475	WEDGE HRDW BAG	1
1.1	010643	5/16" x 3/4" Hex Bolt	8
1.2	010603	5/16" Hex Nut	8
2	501476	WELDMNT, 15 DEGREE WEDGE	1

Parts List: 7.5 Degree Wedge

Item No.	Part No.	Description	Qty
501480 Components			
1	501475	WEDGE HRDW BAG	1
1.1	010643	5/16" x 3/4" Hex Bolt	8
1.2	010603	5/16" Hex Nut	8
2	501486	WELDMNT, 7.5 DEGREE WEDGE	1

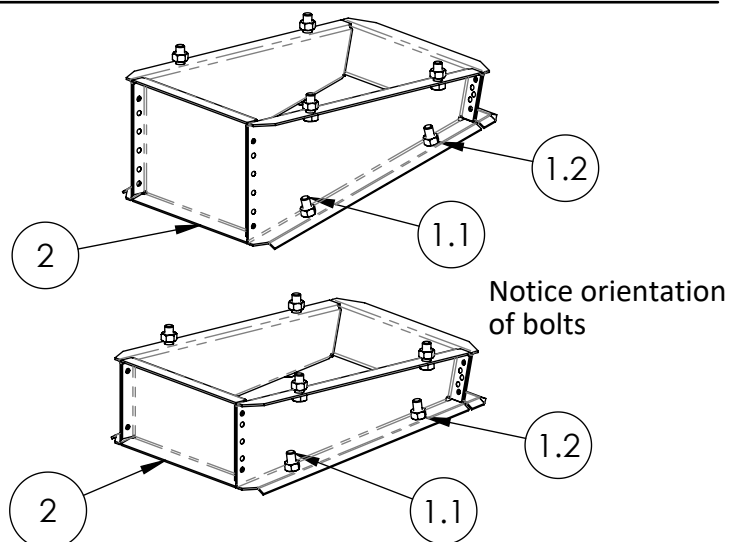

North America:

Phone: 800.99VALCO (800.998.2526)
 Fax: 419.678.2200
 Email: sales@val-co.com

990213 [A] 3/1/2021
 Page 2

International:

Phone: (+1) 419.678.8731
 Fax: (+1) 419.678.2200
 Email: intl.sales@val-co.com