



Quick Sheet Instructions

STEEL TO PVC ADAPTER 3"

Overview:

The 730908 steel to PVC adapter is designed to couple together a 730426 3" steel formed elbow to a 3" PVC tube for 730 3" flexible auger systems.

Installation Instructions:

1. Large side of 730908 adapter gets attached to 3" PVC tube. Small side of 730908 adapter gets attached to 730426 3" steel formed elbow. Dry fit components before gluing or clamping to ensure proper fitment and orientation.
2. Attach plain or cut end of 3" PVC tube to large side of 730908 adapter using PVC cement per the instructions on the PVC cement.
3. Slide 3" steel formed elbow into 730908 adapter until it meets the 3" PVC tube. Secure using 730953 3" tube clamp.
4. After assembly, apply silicone caulk to joint between 730908 adapter and 730426 steel formed elbow.

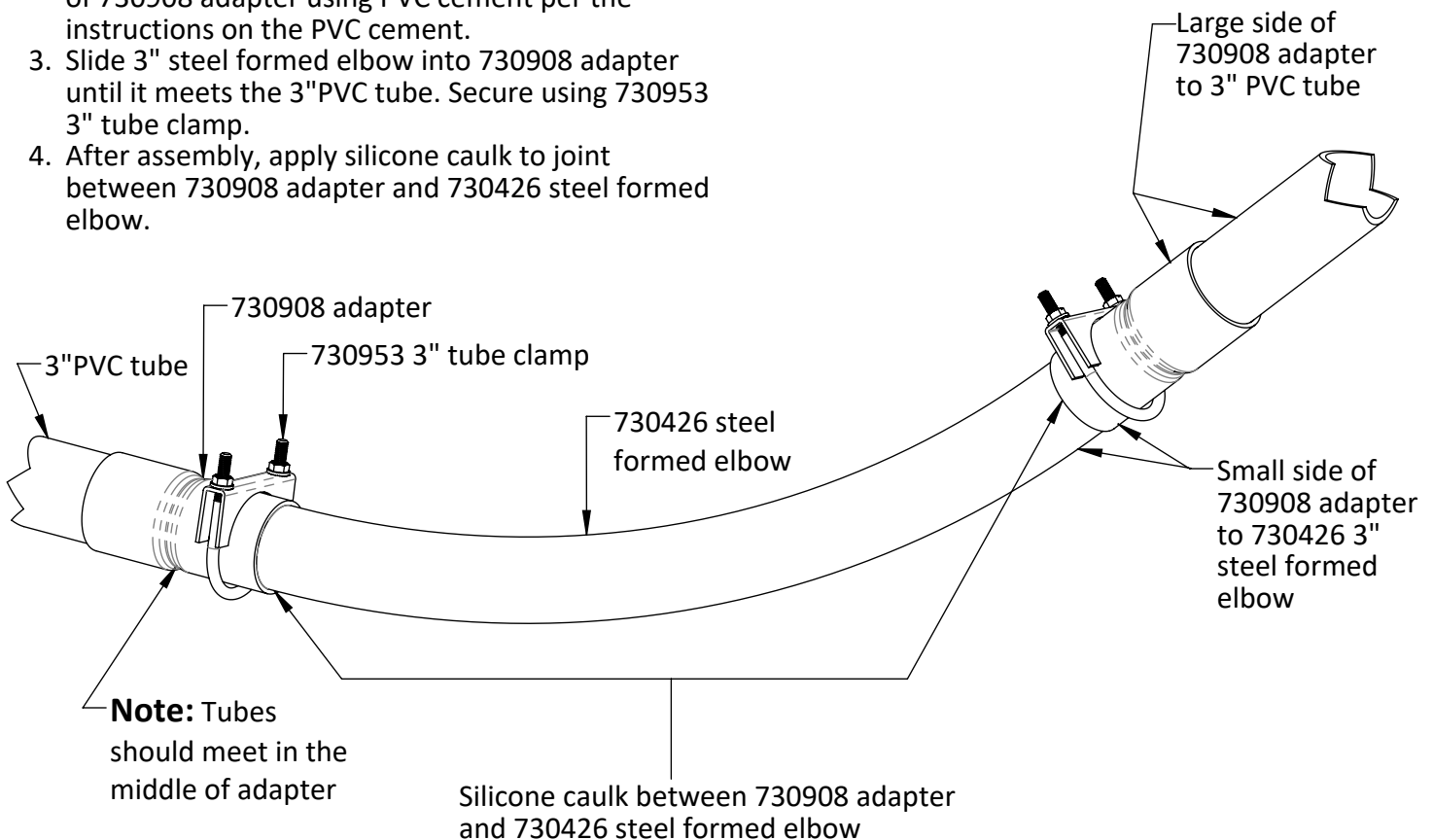
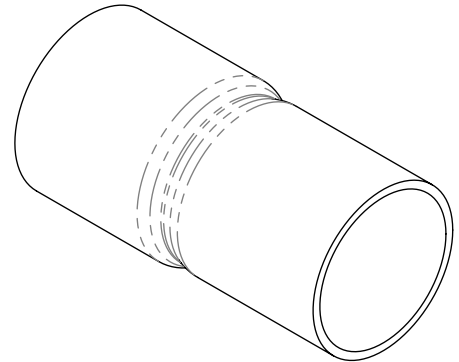

North America:

Phone: 800.99VALCO (800.998.2526)
Fax: 419.678.2200
Email: sales@val-co.com

990259 [-] 6/18/2020
Page 1

International:

Phone: (+1) 419.678.8731
Fax: (+1) 419.678.2200
Email: intl.sales@val-co.com