



# Quick Sheet Instructions

## Slide Valve and Hardware Installation

### Part numbers:

**500471 Single Slide Valve**

**500371 Split Slide Valve**

### Table of Contents

Page 1 - Orientation & Transition Drilling

Page 2 - Caulking Instructions

Page 3 - Hardware Instruction & Operation

Page 4 - Parts List

### Overview

The following pages describe instructions for the installation of slide valves for Straight End Boots, Straight Pass-Thru Boots, and 30 Degree Boots. Please read the entire manual to learn about slide valve orientation, hardware orientation, caulking instructions and replacement part numbers. It is very important all directions are followed for proper operation and weather resistance.

### Slide Valve Orientation

The slide valve should open in the same direction as the feed flows, to ensure optimal feed flow. As shown in **Figure 1**.

**Figure 1**

Valve opens in same direction as feed flow

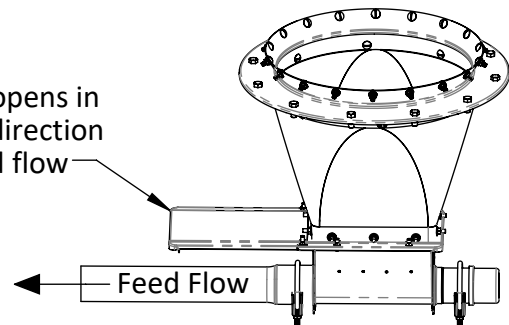

**Straight, End Boot**

Valve opens in same direction as feed flow

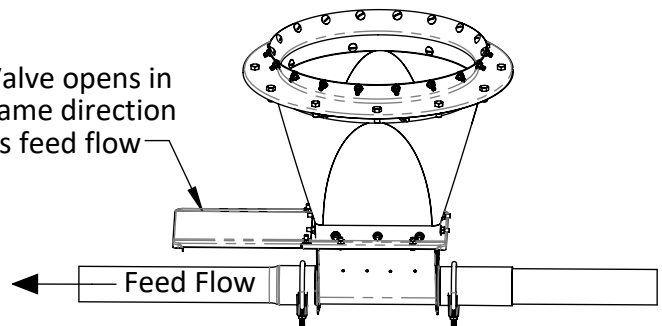

**Straight, Pass- Thru Boot**

Valve opens in same direction as feed flow

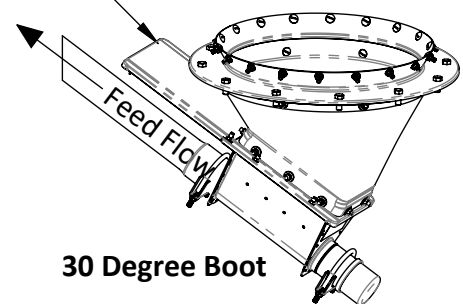

**30 Degree Boot**

**Figure 2**

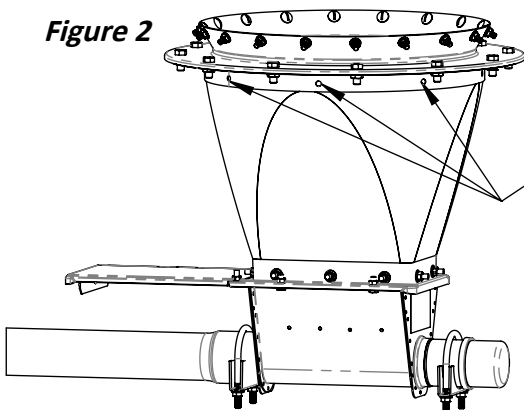

### Drill Holes:

Slide the plastic transition into the bottom collar until it seats against the top collar. Make sure the rectangular opening of the plastic transition is pointed in the desired direction auger will go. Use the bottom collar holes as guides to drill 11/32" (8.8 mm)  $\phi$  holes 8X in the upper rim of the plastic transition. See **Figure 2**.

## Caulking Instructions

To ensure moisture does not seep inside boot, all joints and hardware holes must be caulked properly.

- Clean the locations where caulking is to be applied.
- Use rope caulk supplied with feed bin between collars.
- Use UV resistant silicone caulk and apply between all mating parts as shown in **Figure 3**.
- There must be bead of caulk sealing each hardware hole as shown in **Detail A**.

Reference Feed Bin & Flexible Auger Manuals for more information.

**Figure 3**

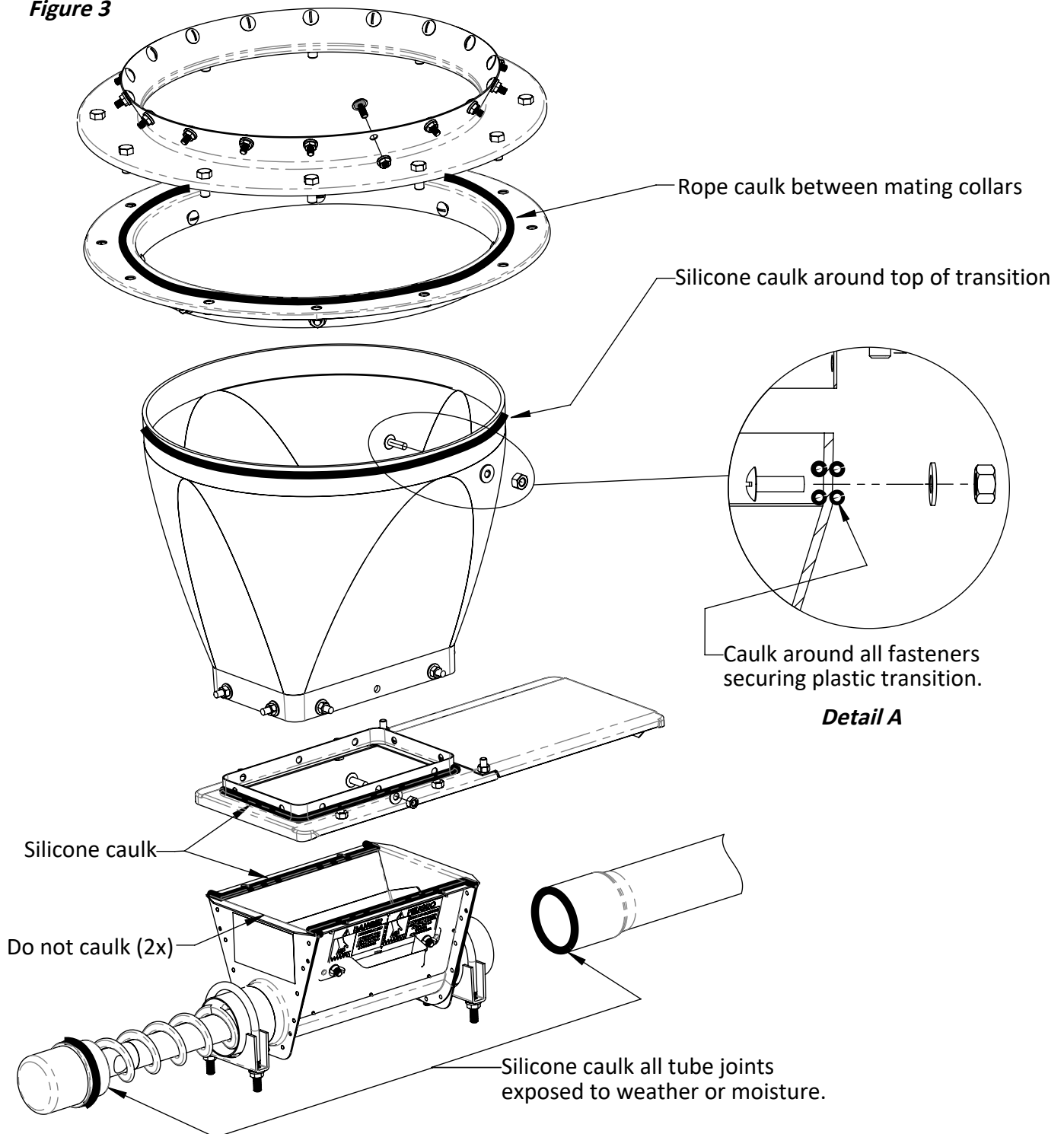

## Hardware Instructions

All tapered sections of the feed bin should be secured with round head truss bolts. It is very important to install the round head inside the bin so feed will flow over. This includes the hardware of the collar to the bin, the bottom collar to the boot transition, and the slide valve to the lower boot, as shown in **Figure 4**.

**Figure 4**

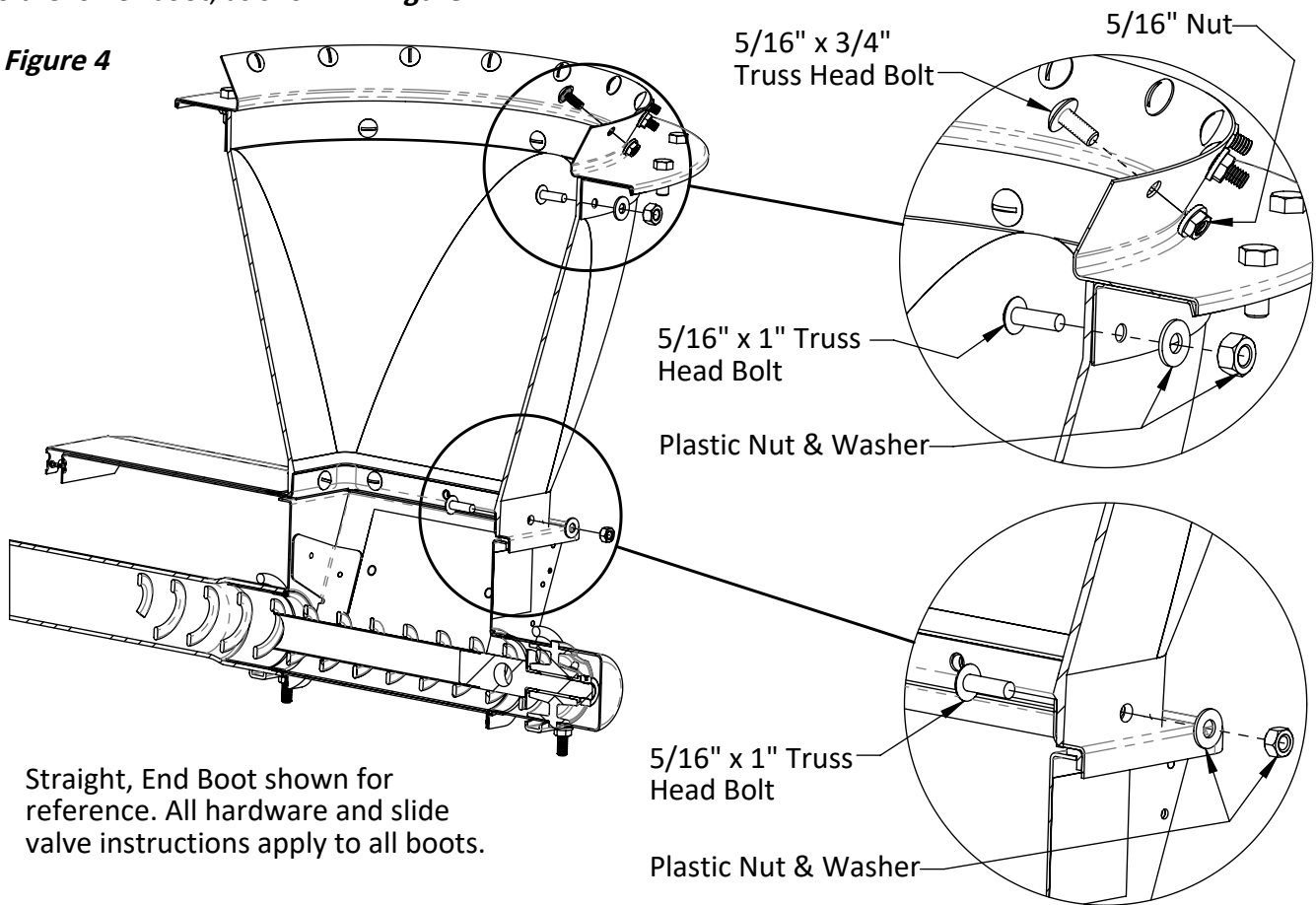

Straight, End Boot shown for reference. All hardware and slide valve instructions apply to all boots.

## Pass-Thru Systems

A pass-thru bin (a bin with no bearing, that the auger passes thru) must have a restrictor plate installed in the boot, as shown in Figure 5. Do not have more than one bin open at the same time while the auger is running. If more than one slide valve is open at the same time, the auger will be overloaded and could jam. Follow the installation instructions provided with the restrictor plates.

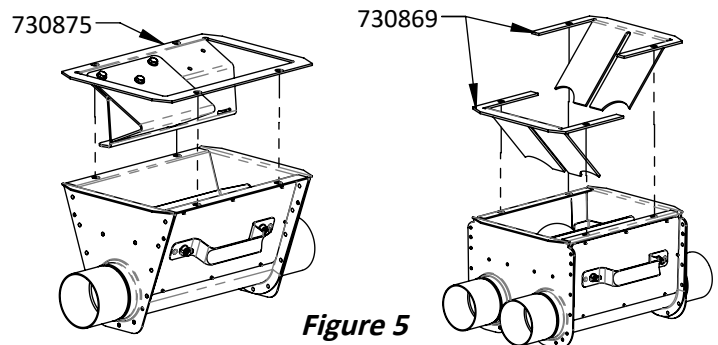

**Figure 5**

## Important Operation Notes

- It is important for NEW auger and tubes to be polished by the moving feed before opening the slide valve the entire way. Otherwise the auger could overload and jam.
- In tandem systems, do not have more than one bin open at the same time while the auger is running. If more than one slide valve is open at the same time, the auger will be overloaded and could jam.
- Do not allow the auger to run empty. Premature wear and damage to components could result.
- Sliding the valve at least once a week will ensure the valve remains operable and free from feed debris.
- Agitator ball included is **ONLY** supposed to be used in feed loads where feed bridging is a problem (hot feed, high moisture, high fat). Remove ball when feed begins to flow freely. **LEAVING BALL INSIDE BIN WILL RESULT IN PREMATURE BOOT WEAR!**

## Parts List

Item No.	Part No.	Description	Qty
500471 & 500371 Common Parts			
1	010544	5/16" x 1" LG Truss Head Bolt	18
2	010603	5/16" Hex Nut	6
3	010643	5/16" x 3/4" LG Hex Bolt	6
4	012660	7/64" x 3/4" Cotter Pin	1
5	012781	5/16" Nylon Hex Nut	18
6	012782	5/16" Nylon Washer	18
7	500305	12" Zinc Plated Chain	1
8	500306	Chain Ring	1
9	500487	Weather Stripping, per ft.	1.25 ft
500471 - Single Slide Valve			
10	500301	Single Slide Plate	1
11	500302	Single Slide Weather Shield	1
12	500309	Single Transfer Plate	1
500371 - Twin Slide Valve			
13	500324	Twin Slide Plate	1
14	500374	Twin Transfer Plate (contains [2] 500324)	1
15	500587	Twin Slide Weather Shield	2

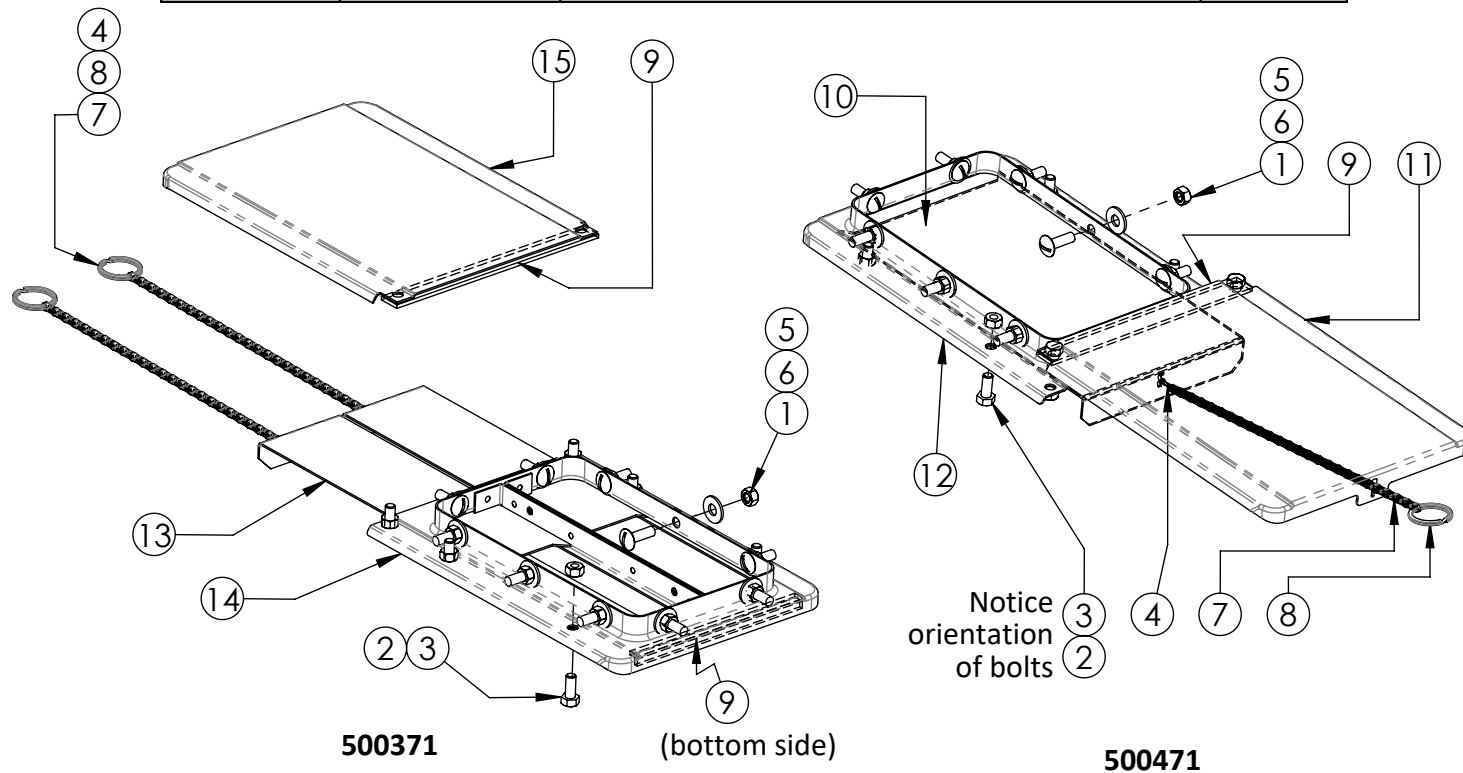

### North America:

Phone: 800.99VALCO (800.998.2526)  
 Fax: 419.678.2200  
 Email: sales@val-co.com

990172 [A] 05/02/18  
 Page 4

### International:

Phone: (+1) 419.678.8731  
 Fax: (+1) 419.678.2200  
 Email: intl.sales@val-co.com