

# Tru-Lok Lid Add-On Lid Opener

## Quick Sheet

### Installation Instructions

The Tru-Lok lid and extension tubes require some assembly, as explained in the steps below.

1. Unfasten 5/16" x 2-1/2" bolt on lid locking collar and rotate lid opener so the bottom bracket is centered over the roof deck seam that aligns with the leg to be used for the lid tube. Tighten bolt on lid locking collar securely. If the lid opener has a latch on the front, remove it to enable the tru-lok kit to function. Refer to Figure 1 for details.
2. Unfasten four closest 010643 5/16" x 3/4" bolts (two for the 30° roof) on the 500655 lid bracket. Assemble left top plate and right top plate to it, reusing the hardware, as shown in Figure 1. Tighten bolts securely.
3. Fasten roof tube between top holes in both lid hinge plates with 010649 5/16" x 1-3/4" hex bolt and 012789 5/16" locknut, as shown in Figure 1. Do not overtighten bolt, roof tube must move freely.
4. Assemble 500709 pivot plate bracket to 500710 backup plate with 010643 5/16" x 3/4" bolt and 012789 5/16" locknut thru bottom hole as shown in Figure 2.

**Figure 1**

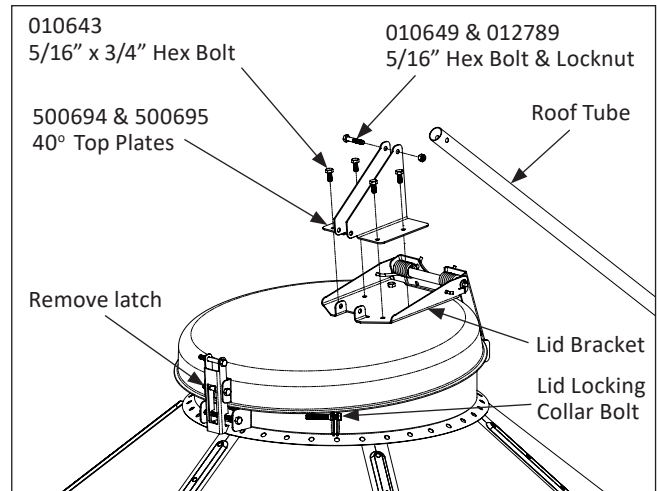

**Figure 2**

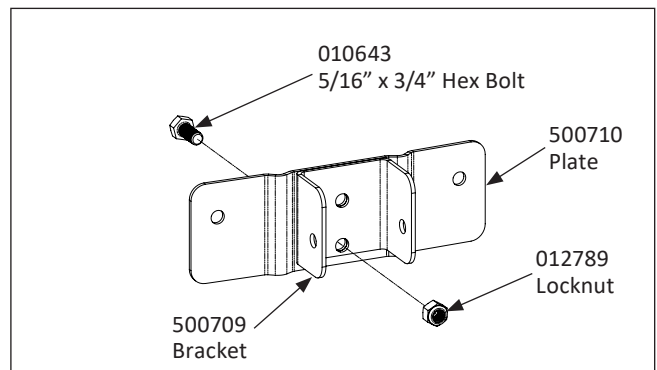

**Figure 3**

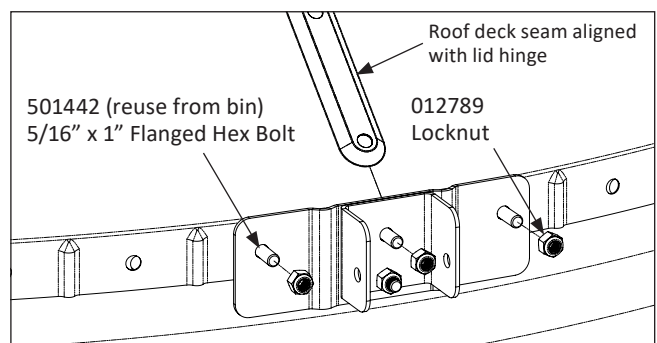

5. To assemble pivot plate to bin remove (3) 501442 5/16" x 1" bin bolts from holes in roof deck & hopper seam, in-line with roof deck seam that is aligned with the lid hinge bracket. Re-use bin bolts to attach bracket to bin with 012789 5/16" locknuts, as shown in Figure 3.

## Installation Instructions (continued)

6. Assemble side marked "TOP" of (2) 500704 pivot plates to the end of the roof deck tube with (2) 010649 5/16" x 1-3/4" bolts and 012789 5/16" locknuts. Assemble bottom side of pivot plates to the pivot plate bracket using (2) 010643 5/16" x 3/4" bolts and 012789 5/16" locknuts. Refer to Figure 4 for details. Do not overtighten bolts, pivot plates need to be able to move freely.
7. Fasten top 500729 tube extensions to pivot plates with (1) 010649 5/16" x 1-3/4" bolt and 012789 5/16" locknut per tube, as shown in Figure 4. Use same hardware to fasten additional extension tubes and 500226 basic tube. Tubes can be assembled as bin is built.

Figure 4

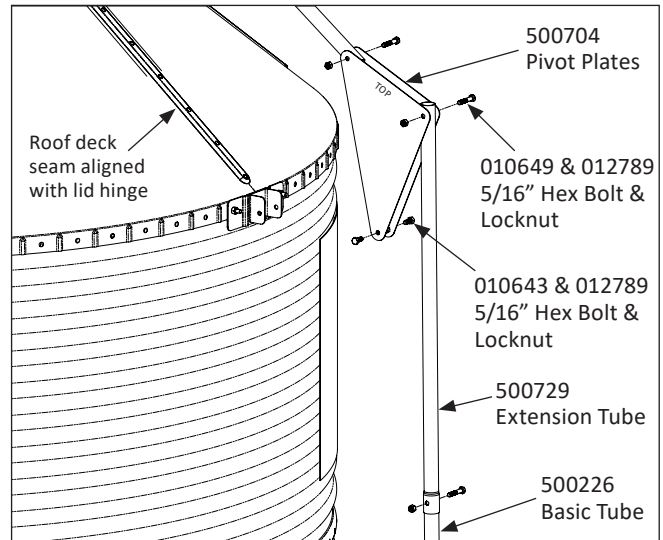

**Attach pivot plate brackets below roof deck seam aligned with lid hinge.**

8. Place 500257 pinch handle assembly on bin leg approximately 60" from bottom of bin and fasten with (2) 500719 clips and (2) 010649 5/16" x 1-3/4" bolts and 012789 5/16" locknuts, as shown in Figure 5.

**NOTE: Exact height can be adjusted for your comfort after bin is erected.**

9. Slide 500230 tube handle over bottom of tube and place tube thru pinch handle. Close lid and cut tube to desired length. Secure handle approximately 2" above bottom of tube with 011434 1/4" x 1" carriage bolt and 010943 1/4-20 wing nut, as shown in Figure 5. Wet inside of rubber handle grip to ease assembly when sliding grip over handle.

Figure 5

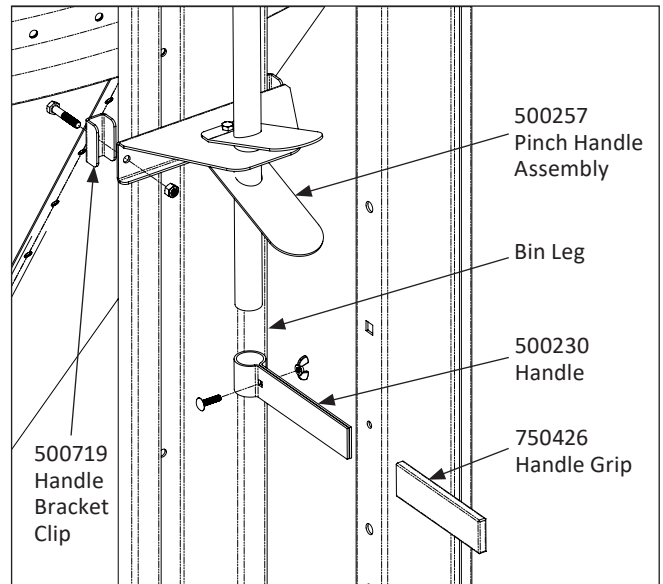

**NOTE:** 500728 tube guide should be installed on 3-7 ring bins only, to help stabilize tubes. Remove (3) 501441 5/16" flange nuts and 501442 flange hex bolts from bin and reuse to attach tube guide to bin, as shown in Figure 6. Install halfway between pivot and pinch handle assembly.

Figure 6

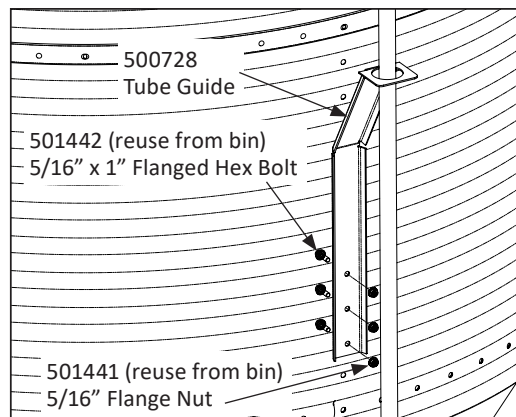

## Replacement Parts List

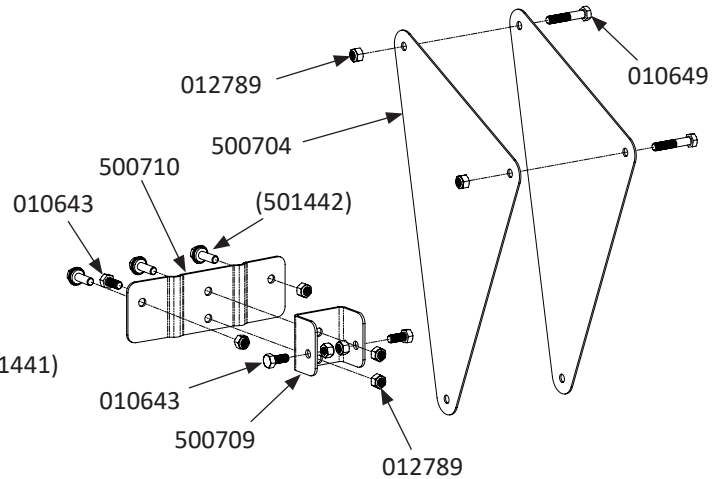
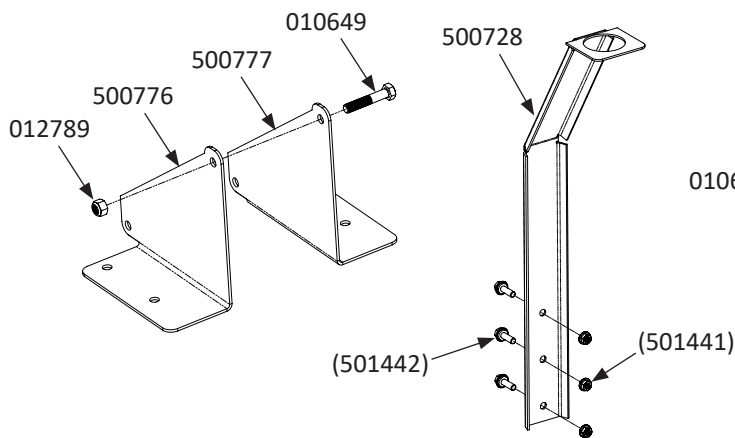

PART #	DESCRIPTION	QTY
<b>Tru-Lok Replacement Parts (quantities will vary)</b>		
010126	1/2" Medium Load Spring	-
010625	1/4-20 x 2" Hex Bolt	-
010643	5/16-18 x 3/4" Hex Bolt	-
010649	5/16" Hex Bolt	-
010943	1/4-20 Wing Nut	-
011434	1/4-20 x 1 Carriage Bolt	-
012789	5/16" Locknut	-
012793	1/4-20 Nylock Nut	-
500228	Pinch Opener Mtg Bracket	-
500229	Pinch Opener Handle	-
500230	Handle	-
500257	Pinch Handle Assembly	-
500704	Pivot Plates	-
500709	Pivot Plate Bracket	-
500710	Backup Plate	-
500719	Handle Bracket Clip	-
500728	Tru-Lok Tube Guide (3-7 ring bin only)	-
500776	Left Top Plate	-
500777	Right Top Plate	-
750426	Hand Grip	-

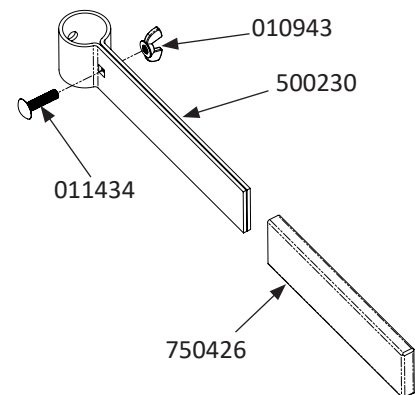
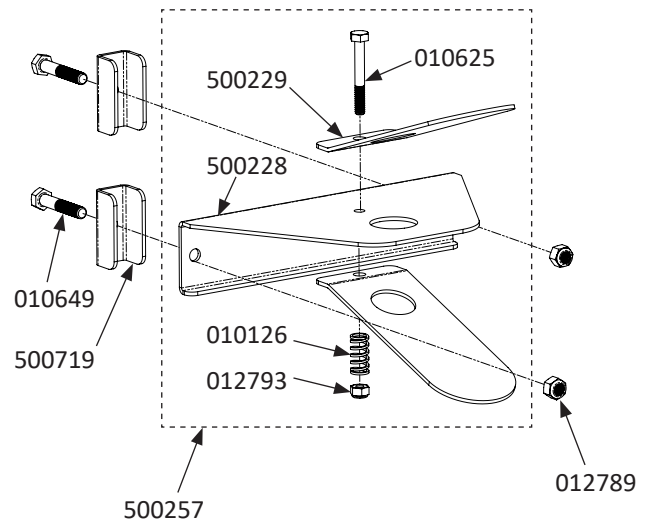

**NOTE:** 501441 5/16" flange nuts & 501442 5/16" X 1" flanged hex bolts come with the bin, and are reused to attach the 500710 backup plate and/or 500728 tube guide to the bin.

## Tru-Lok Lid Opener Tubes and Usage

Charts are included on this page to help with the installation of lid opener tubes. Please note the difference between the 500729 Extension Tube (one belled end) and 500763 Extension Coupler Tube (two belled ends).

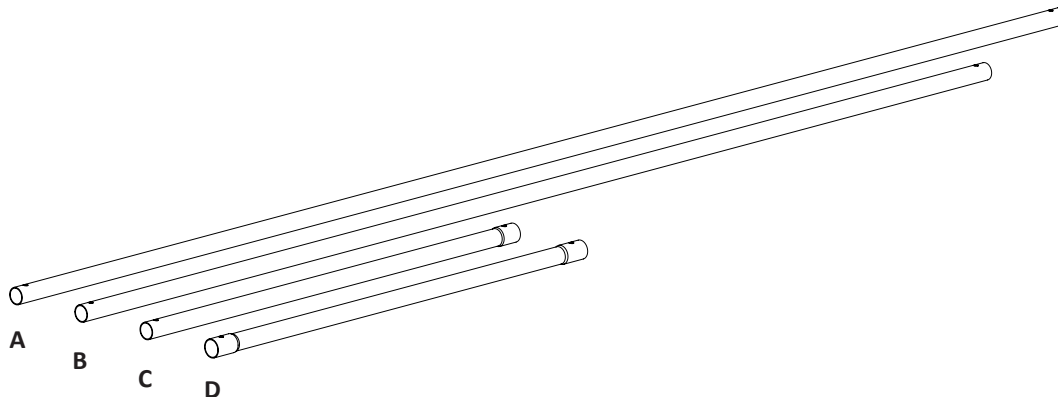

KEY	PART #	DESCRIPTION	TUBE LENGTH	QTY
<b>Tru-Lok Tubes</b>				
A	500226	Tru-Lok Basic Tube (as per bin size)	96.13" [2441.6mm]	1-3
B	506725	Tru-Lok 40° Roof Tube - 6' (1 per bin size)	36.39" [924.3mm]	1
	507727	Tru-Lok 40° Roof Tube - 7' (1 per bin size)	43.59" [1107.2mm]	1
	509727	Tru-Lok 40° Roof Tube - 9' (1 per bin size)	59.74" [1517.4mm]	1
	512727	Tru-Lok 40° Roof Tube -12' (1 per bin size)	83.25" [2114.6mm]	1
C	500729	Tru-Lok Extension Tube (1 end belled)	33.81" [828.8mm]	0-6
D	500763	34" Extension Coupler Tube (2 ends belled)	34.00" [863.6mm]	0-2

6 FT BIN - TUBE USAGE CHART				
Tube Part No.	Roof Tube 506725	Basic Tube 500226	Ext. Tube 500729	Ext. Coupler 500763
1 Ring Bin (570641)	1	1	0	0
2 Ring Bin (570642)	1	1	1	0
3 Ring Bin (570643)	1	2	2	0
4 Ring Bin (570644)	1	2	3	0

7 FT BIN - TUBE USAGE CHART				
Tube Part No.	Roof Tube 507727	Basic Tube 500226	Ext. Tube 500729	Ext Coupler 500763
1 Ring Bin (570741)	1	1	1	0
2 Ring Bin (570742)	1	1	2	0
3 Ring Bin (570743)	1	1	3	0
4 Ring Bin (570744)	1	1	4	0
5 Ring Bin (570745)	1	1	5	0
6 Ring Bin (570746)	1	1	6	0

9 FT BIN - TUBE USAGE CHART				
Tube Part No.	Roof Tube 509727	Basic Tube 500226	Ext. Tube 500729	Ext. Coupler 500763
1 Ring Bin (570941)	1	1	1	0
2 Ring Bin (570942)	1	1	2	0
3 Ring Bin (570943)	1	1	3	1
4 Ring Bin (570944)	1	1	4	1
5 Ring Bin (570945)	1	1	5	1
6 Ring Bin (570946)	1	1	6	1

12 FT BIN - TUBE USAGE CHART				
Tube Part No.	Roof Tube 512727	Basic Tube 500226	Ext. Tube 500729	Ext. Coupler 500763
1 Ring Bin (571241)	1	1	2	0
2 Ring Bin (571242)	1	1	3	0
3 Ring Bin (571243)	1	2	0	1
4 Ring Bin (571244)	1	2	1	1
5 Ring Bin (571245)	1	2	2	1
6 Ring Bin (571246)	1	2	3	1
7 Ring Bin (571247)	1	3	0	2

### North America:

Phone: 800.99VALCO; 800.998.2526

Fax: 419.678.2200

Email: [sales@val-co.com](mailto:sales@val-co.com)

### International:

Phone: (+1) 419.678.8731

Fax: (+1) 419.678.2200

Email: [intl.sales@val-co.com](mailto:intl.sales@val-co.com)