



# 36" Box Fan Installation

936425-ZM, 936435-ZM

Quick Sheet

## **WARNING**

Do not install fan with moving parts within seven feet of floor or grade level without a guard that complies with OSHA Regulations. Do not use unless electrical wiring complies with all applicable codes. Do not wire without providing for power source disconnect at the fan itself. Do not service except by a qualified maintenance technician and only after disconnecting the power source. Do not install in room where flammable material is stored or flammable vapors might build up. Failure to observe all of these precautions can result in serious injury or death.

### 36" Box Fan Installation Instructions

#### **STEP 1**

Check direction: The blade should rotate counterclockwise from the motor end, as shown.

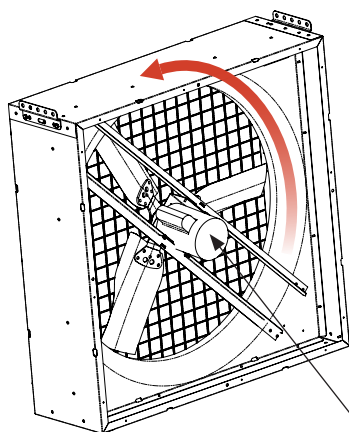

Wire up motor

#### **STEP 2** (Optional)

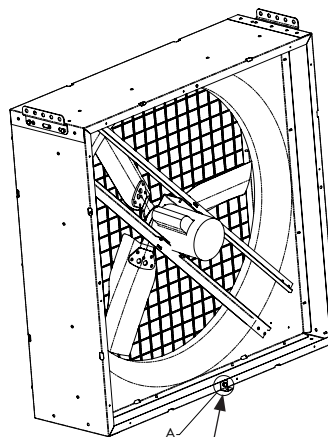

Install 936191-ZM

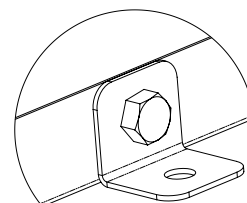

**DETAIL A**  
(Assembled)

5/16-18 X 1/2" bolt



936191-ZM

5/16-18 flange nut

## 36" Box Fan Installation Instructions - continued

### STEP 3

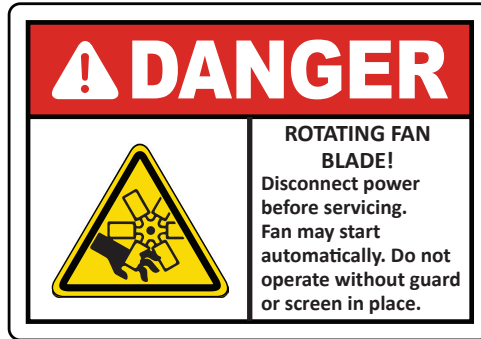
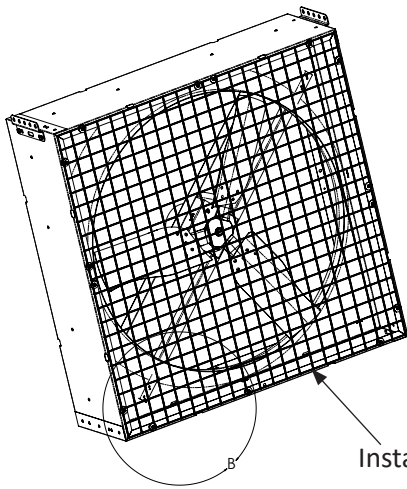

DETAIL B

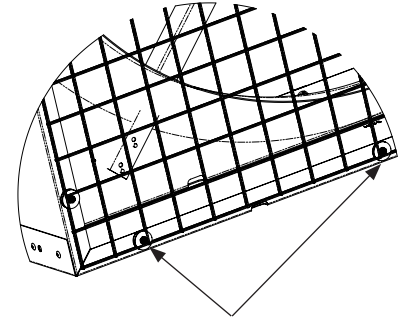

Install wire guard onto both sides of box fan with washers and screws, as shown.

### STEP 4

Box fan shown suspended with 936187 brackets and cable.

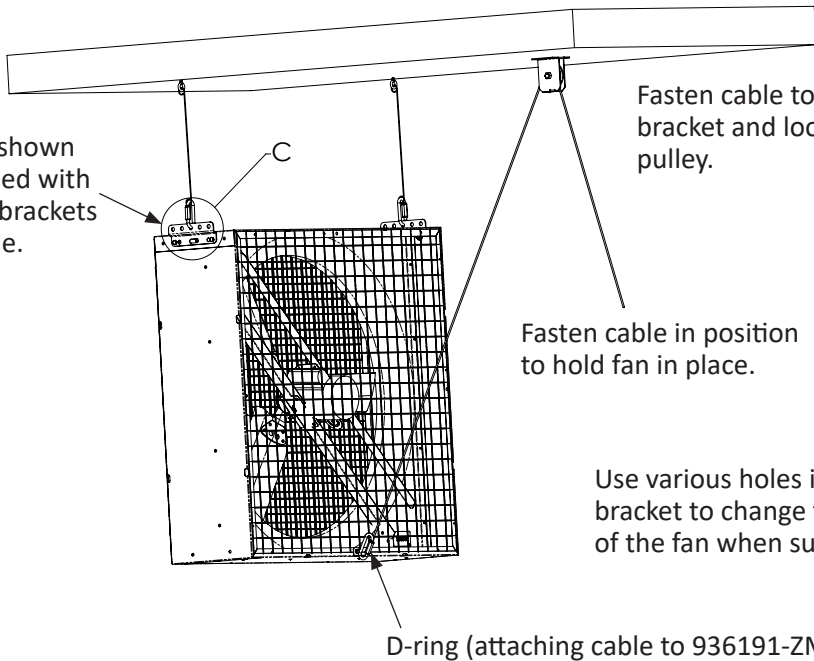

**NOTE:** Suspension hardware not included.

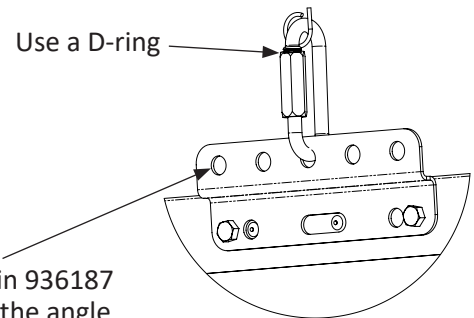

DETAIL C

#### North America:

Phone: 800.99VALCO; 800.998.2526

Fax: 419.678.2200

Email: [sales@val-co.com](mailto:sales@val-co.com)

990320

REV [A]

#### International:

Phone: (+1) 419.678.8731

Fax: (+1) 419.678.2200

Email: [intl.sales@val-co.com](mailto:intl.sales@val-co.com)